

# KUNSHAN XINXIUYI KINDERGARTEN

## 昆山新绣衣幼儿园

用地面积 14 535平方米  
建筑面积 15 704 平方米  
设计时间 2011年12月  
建筑类型 文化教育建筑

**村庄/消融:**设计借鉴传统村庄格局,以9个盒子消解30个班级的大体量并形成相对独立的单元式聚落空间,有机的聚落产生趣味场所并形成多层次公共空间,尺度也更适合儿童活动要求。

**园林/游廊:**9个生活单元和公共空间被一条曲折的“廊子”串联,这条路径来源于对苏州古典园林网师园的解读,悬浮在空中的路径在林霭与光线中穿行,转折处产生微妙的空间感受和对景。

**表皮/绣衣:**“绣”字出现在本案名称以及当地传统苏绣工艺中,由此得到灵感形成建筑表皮,彩色竖向遮阳板如细密的针脚编织成霓裳,包裹整个建筑,简洁而富于色彩变化的表皮使各单元形成差异化的性格特点,契合儿童心理,实现“糖果村庄”的原初设计想法。

Village/Melt

The design makes references to the layout of traditional village, filling 30 classrooms in nine buildings and forming a relatively independent unit-type settlement space. Organic settlement creates interesting locations and diversified public spaces, whose scales are appropriate for children activities.

Garden / Veranda

Nine living units and public space are connected with each other through a piece of zigzag "veranda", which is inspired from the classical garden of Suzhou, the Master-of-Nets Garden. The path floating in the air spreads out in forest fog and sunshine, providing delicate spatial and visual experiences at turnings.

Skin / Embroidery

"Xiu" (embroidery) is used in the name of this project and it is a skill in local traditional embroidery process of Suzhou. The design concept is inspired from embroidery which is used for decoration of building skin. Colorful vertical sunshades are like fine and dense pinpoints which weave a piece of beautiful cloth wrapping the whole building. Simple but colorful appearance forms different characteristics of each unit, satisfying children's mind and realizing original and preliminary design concept of "candy village".

### 村

布局

· 家族聚落  
· 有机格局



### 园

文脉

· 苏州园林  
· 地域性



### 绣

表皮

· 苏绣  
· 绣衣镇



left comparative analysis with the Master-of-Nets Garden  
/与网师园的对比分析  
right structure and bird's eye view/鸟瞰图和组织结构

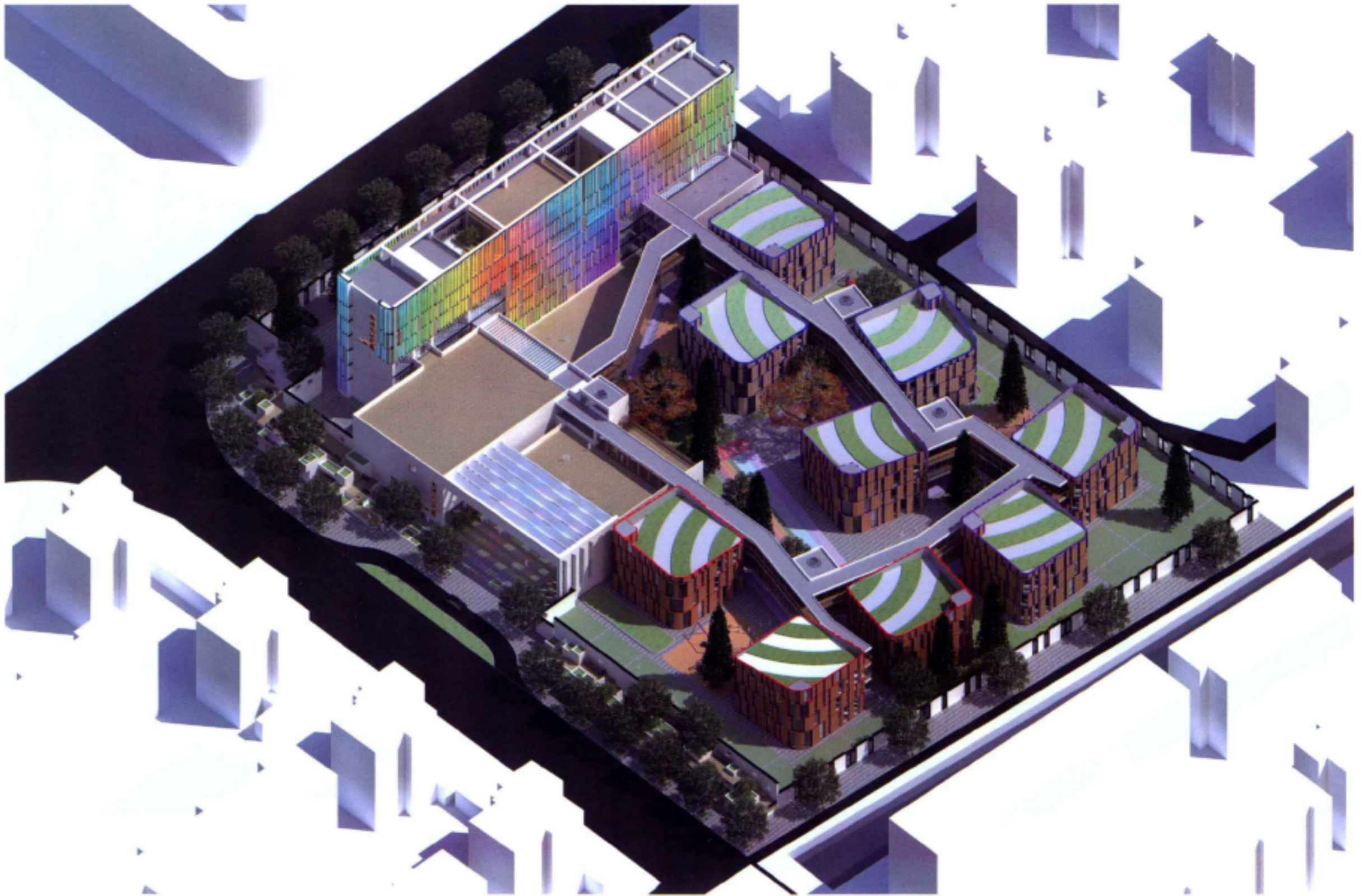

corridor/走廊

class room units/班级单元

entrance hall / 入口大厅

administrative office building / 行政办公楼

fencing / 围墙



+



+

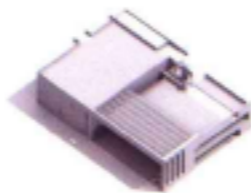

+



+

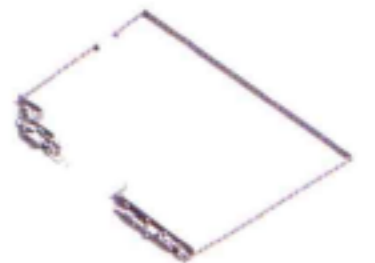



top left bird's eye view/鸟瞰图  
 top right perspective/透视图  
 bottom left north facade/北立面  
 bottom right west facade/西立面



