

Asan Baebang Mixed-Use Complex – Second Place

牙山城市综合体二等奖

Location: Asan, South Korea **Designers:** DRDS Architecture **Photographers:** DRDS Architecture
Competition date: 2008 **Total area:** 612,000 sqm
Competition scale: International competition
Competition name: Asan Baebang Mixed-Use Project
Competition Organiser: Asan City Government **Place in the competition:** Competition entry second place

项目所在地: 韩国, 牙山 设计师: DRDS建筑事务所 摄影师: DRDS建筑事务所 参赛时间: 2008年 建筑面积: 612,000平方米 竞赛规模: 国际竞赛 主办方: 牙山市政府 竞赛所获名次: 竞赛入围二等奖

The design for Asan Baebang features a new 69-storey landmark high-rise for a redevelopment project located in Asan, South Korea. The mixed-use project consists primarily of officetel and office components housed within 4 high-rise towers. These include 114 residential condominiums. A multi-function podium, including culture, research, healthcare, commercial and public space unites the project at the base. The project size is 612,000 sqm. The site area is 51,379 sqm. The site coverage is 70%. The site is nestled between a hilly woodland to the west and Jangjae Creek to the east. The KTX Chunan Asan Express Railway Station is within a short walking distance. Proximity to the bus line system and pedestrian/bicycle circulation routes also link the project with the rest of Asan in an efficient and sustainable manner. The featured high-rise tower is 69 storeys with a total area of 204,805 sqm consisting of 60,600 sqm of office and 78,400 sqm of officetel including 114 residential units. The average floor plate size is 1,800 sqm. Floor plates are designed with efficient lease depths in mind. The angular façade creates a crystalline effect that dynamically reflects and harmonises with the sky. Towers A and B are 47 storeys in height consisting of officetel with a total area 178,625 sqm. They are focused on family-oriented living. Typical floor plans consist of 9 units facing southeast, south and southwest. This configuration, based on desirable views, inform the tower shape. Tower C is 37 storeys in height consisting of officetel with a total area 158,475 sqm. The tower consists of small sized residential units. The building form reflects ground configuration of a public park and offers bridges that are linked to the north hill. Each unit is oriented to the southeast with a view of the public park.

牙山城市综合体以创建69层地标性建筑为焦点,同时打造其他3个高层建筑,为114户居民提供住宅公寓。该综合体作为一个多功能平台,集文化、科研、医疗、商业和公共空间于一体,真正实现了空间功能的多元化利用。项目总面积为612,000平方米,建筑面积为51,379平方米,建筑覆盖率为70%。该综合体位于丘陵林地与Jangjae河之间,与淳安-牙山的高速铁路站相距不远。附近的巴士线路和行人/自行车通道为打造高效、可持续发展的规划项目创造了有利条件。69层高大楼占地204,805平方米,内设60,600平方米办公区,78,400平方米酒店写字间,包括114户住宅。平均每层占地1,800平方米。楼层间的布局以租赁式作为出发点。多角度的外观犹如一颗璀璨的水晶,与湛蓝的天空构成一幅美妙的画卷。A、B两座大厦均为47层,酒店写字间占地178,625平方米。该空间以家庭生活为主。典型、传统的平面布局中设有9个单元,分别为东南向、南向和西南向。方位的巧妙设置便于观赏室外景致,同时造就了大楼独特的形状。C座大厦共37层,酒店写字间占地面积为158,475平方米。该空间内主要是小型住宅单元。建筑的外观与地面公共停车场的设置遥相呼应,并与北部山区进行自然衔接。每个住宅空间均设置为东南向,住户于此可以饱览公共停车场的景致。

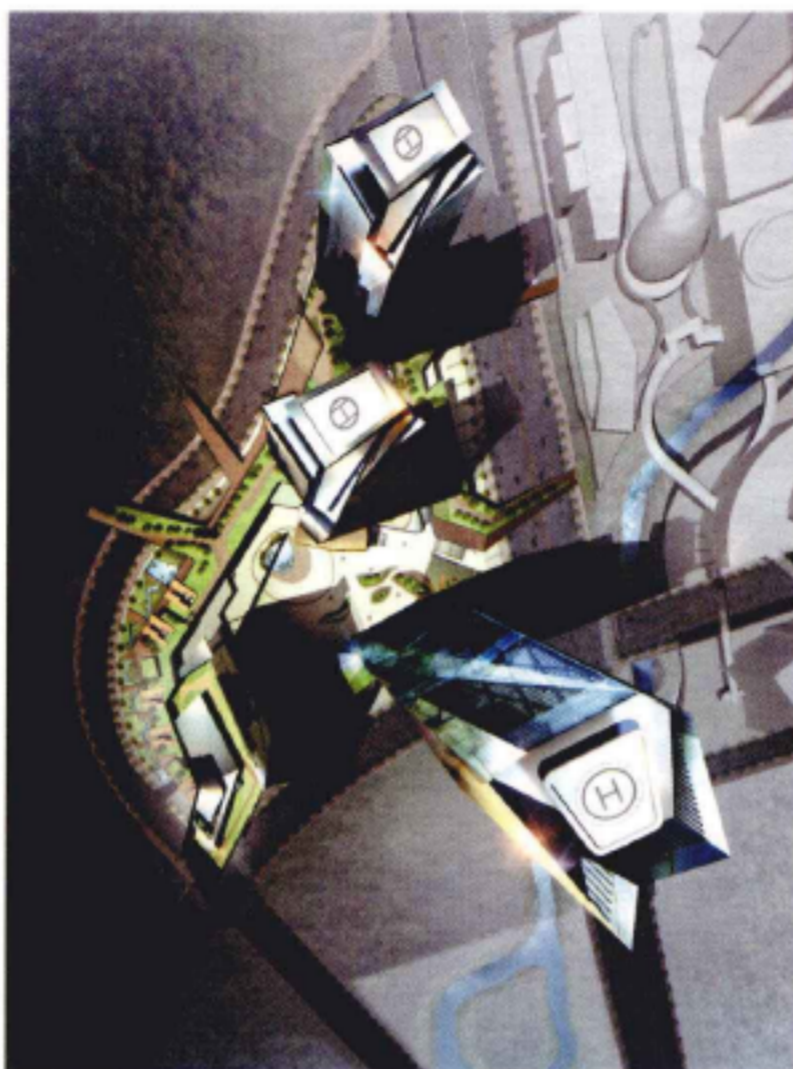

Awarded reason:

Asan Baebang Mixed-Use Project is an integral part of the Asan New City Development Plan, a 3,683,200 sqm new city. The development goal is to provide a base area as a self sufficient, multi-functional city, linked to the National Capital and Administration District, which will shift its function and focus to Asan.

获奖原因:

牙山城市综合体是牙山新城市发展规划的一部分,该规划的目标是打造一个自给自足,多元化新城市,为国会和国家行政区域的转移创造先决条件。

Award information:

The Asan City Government held the "Asan Baebang Mixed-Use Project Competition" in March, 2008 in Asan, South Korea. It is a privately-financed international competition with many participants invited, including DRDS Architecture. The project presented here received the second place in all the competition entries.

奖项信息:

牙山市政府于2008年3月举办了牙山城市综合体设计竞赛,本次大赛为个人赞助国际竞赛,来自世界各地的设计团队参加了该竞赛。DRDS建筑事务所在本次竞赛中获得了二等奖。

