

# Shanghai-Pudong Museum

Opposite the historically grown city centre of Shanghai a new "Manhattan" comes into being on the other side of the river: the district Shanghai-Pudong with the highest office – and hotel building at present in China. The Shanghai-Pudong Museum is one of the most important urban projects in this new district. It is supposed to document and archive the district's history and development comprehensively. At the same time modern multifunctional and open exhibition spaces are created to inform the public with a permanent exhibition and special exhibitions about selected topics.

Three elements form the building complex: the square-shaped horizontally orientated glass body with exhibition halls, a much broader, four-metre-high base with surrounding stairs, which accommodates the archives, and a bar-shaped building on the eastern side for the administration. The base as one of the main architectural features of the museum lifts the main building with the exhibition halls above the level of the surrounding streets and emphasises the central importance of the complex. Simplicity and reduction of the materials dominate the clear cube. The façade of the upper, closed part of the main building not only serves as weather protection but also as a communication surface. It is made of two parallel façade-layers. The outer layer consists of glass and the inner one of room-high closed wall panels. These elements can be rotated along their longitudinal axis and can be opened or closed, according to the particular requirements of the exhibition concept, so that views from the inside to the outside and vice versa are generated.

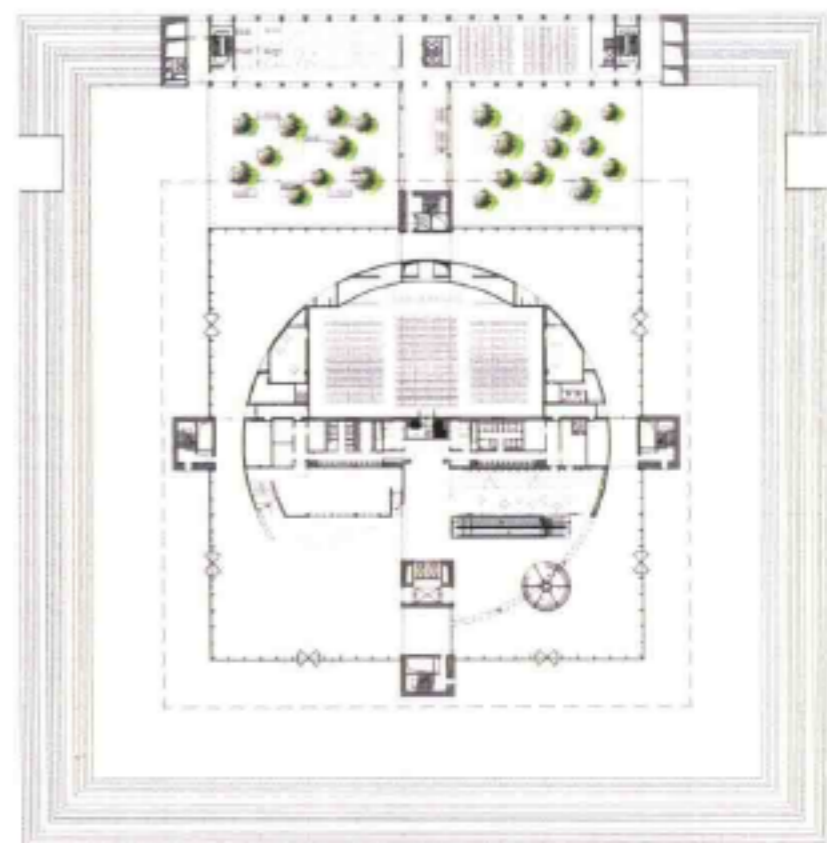

## 上海浦东博物馆

曼哈顿大厦巍然耸立在上海老城中心的对岸，至此浦东新区再添一幢新建筑。浦东博物馆同样位于全新城区内，用于记载这一区的历史及发展，同时也设置着多功能现代展览空间，以永久展览及专项展览的方式诠释着各种不同的话题。博物馆大厦主要由三部分构成：方形的玻璃结构（用作展厅）、4米高的基座（四周设计有楼梯，用于贮藏文件）以及东侧的行政管理大楼。其中基座作为整幢建筑的特色将展厅“托起”，简约而功能性十足。主建筑上层外观共为两层，外层为玻璃，内层为封闭的墙板，既可阻挡风雨的侵蚀又可用作媒体幕墙。



General view 全景图



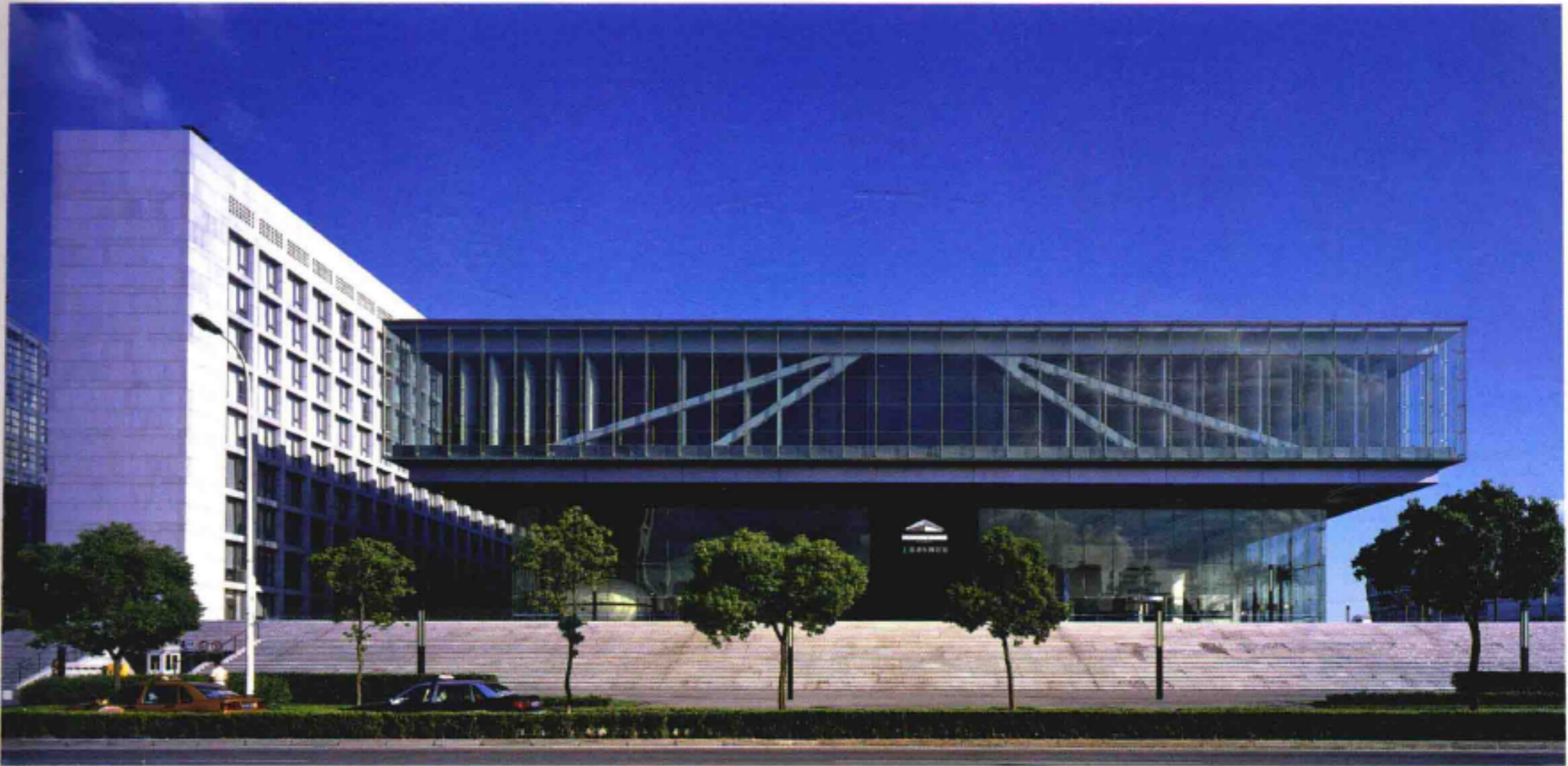

建筑正面 Front view



夜景 Night view

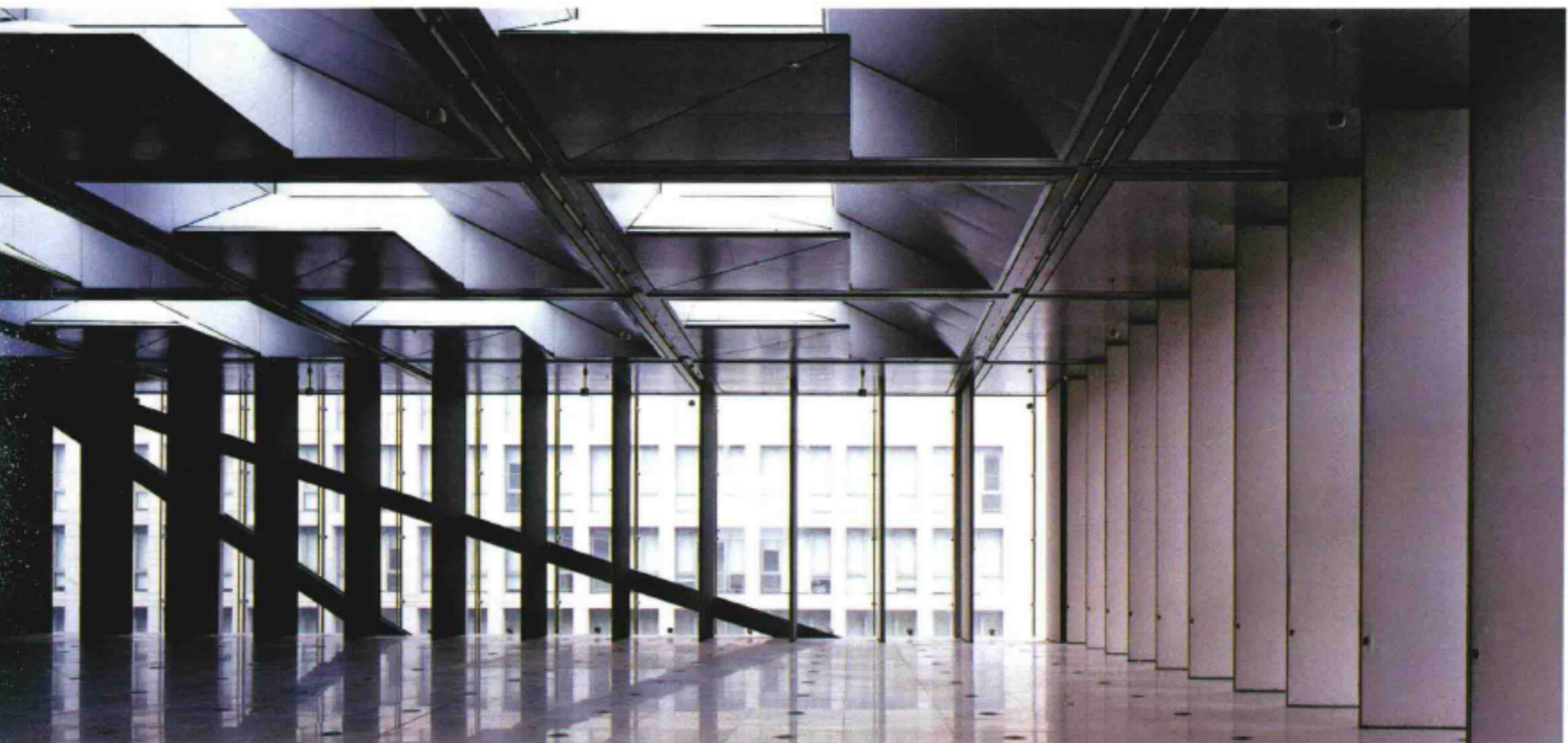

室内 Interior view

Photo: Christian Gahl, Berlin

Cultural

Completion Date: 2005

Architect: Gmp – Von Gerkan, Marg and Partners Architects