

KUNSHAN 21 NEW CITY KINDERGARTEN AND SCHOOL

昆山21新城幼儿园及学校

用地面积 48 506平方米
建筑面积 34 214平方米
设计时间 2009年至今
建筑类型 教育

below kindergarten site plan/幼儿园总平面图
top right bird's eye view/鸟瞰图
bottom right exterior view/外景图

幼儿园的设计以幸运草为灵感，自由生长的四片叶子提供了可灵活分布的四个组团空间。靠近主入口的一片为辅助及办公空间；另三片叶子则以6~9个班为一组围合，拥有各自的专用教室和音体教室，便于教学和活动的分布安排。四片叶子中心是门厅和家长等候区域，主入口处的草茎则是一面嵌有儿童活动主题的弧形剪影墙，将人们从城市道路导入幼儿园门厅。

学校用地的西侧以弧形小区道路为界面。建筑的沿街形态成为设计难点。教室功能的理性要求与弧形边界所形成的张力使五个院落空间有机错位，形成了与基地形状有机契合的空间形式。此外，二层共享平台的引入创造了更多的师生交流机会和可以停留的趣味空间。

The kindergarten is designed according to the shape of four-leaf clover, and the four freely-growing leaves realize flexible distribution of four blocks. The leaf near the main entrance is designed as auxiliary and office spaces, while the other three leaves are designed as classrooms, among which six to nine classrooms form a group to provide dedicated classroom, music classroom and sports classroom, so as to be convenient for arrangement of teaching and sports activities. Hallway and parents waiting area are designed at the center of the four leaves. The caulis at the main entrance is designed into an arch picture wall on which children's activity themes are exhibited, leading people from the urban road to the hallway of kindergarten.

The west boundary of the site is defined by an arch community path. Building appearance along the street is a design difficulty. Rational requirement of teaching classroom and flexibility of arch boundary realize organical stagger layout among the five courtyards, creating a spatial form favorably adapting to the site shape. Furthermore, a shared platform designed on the second floor provides more interesting spaces for teachers and students to communicate and rest.

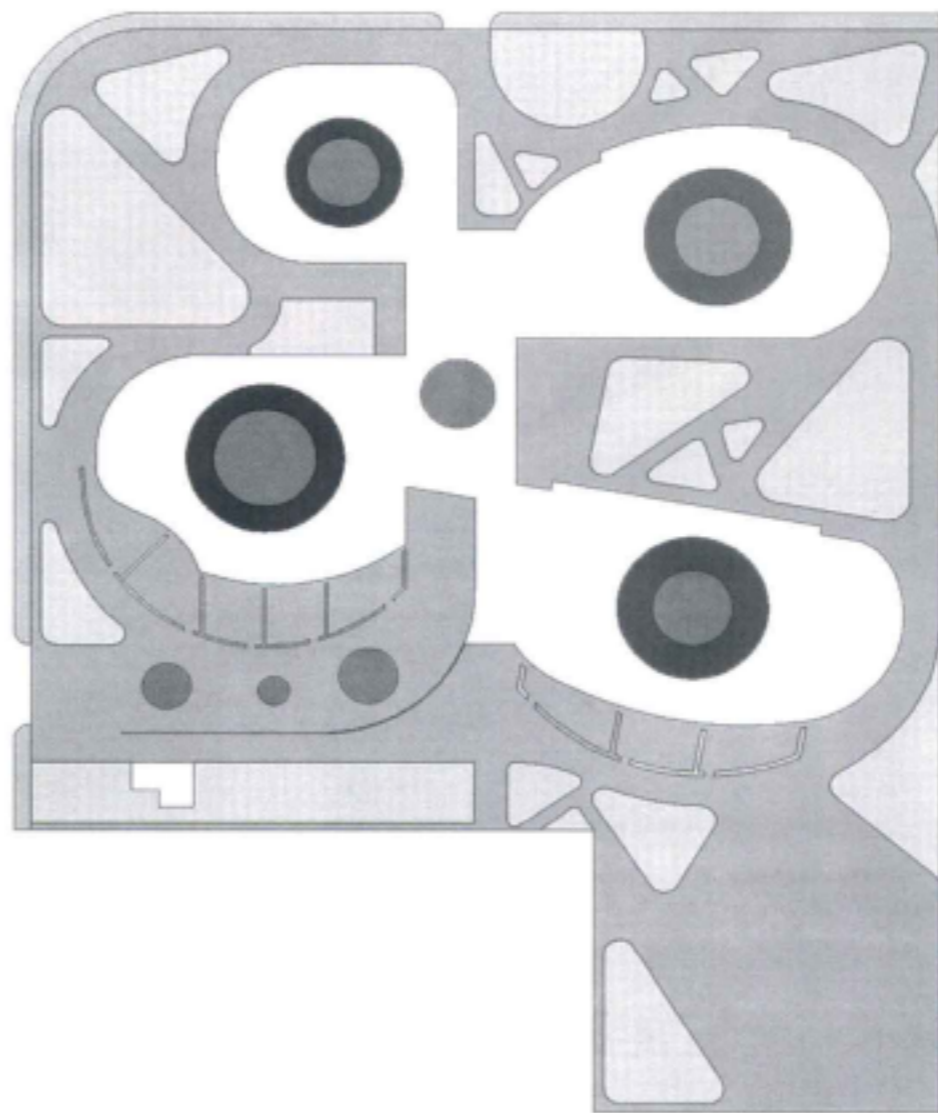



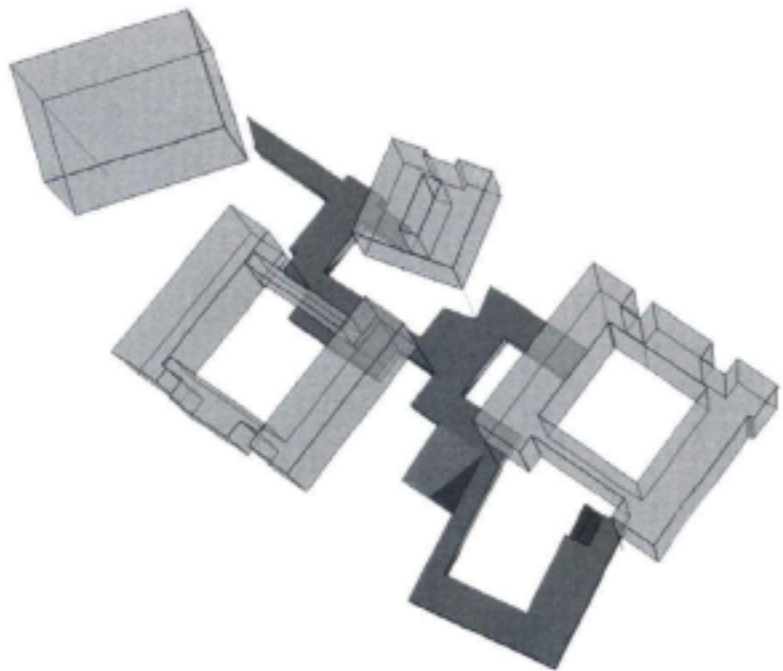



top left bird's eye view/鸟瞰效果图
bottom left concept diagram/概念图解
above exterior view/外景效果图