



建设地点 天津市河西区友谊路

主要用途 综合接待

总建筑面积 22 479 m²

层数 地上3层,地下1层

总高度 14.6 m

结构形式 框架结构

设计/竣工时间 2002年/2004年

Location Youyi Road, Hexi District, Tianjin

Main Use Reception

Total Floor Area 22,479 m²

Floor Levels 3 floors above-ground, 1 floor under-ground

Total Height 14.6 m

Structure Frame structure

Design 2002/2004

天津市迎宾馆四号楼

NO.4 Building of Tianjin Guest House

该建筑是我市接待国内贵宾的主要场所。设计理念是将该建筑与自然环境有机结合,与迎宾馆内其他建筑取得形式上的统一,并突出自身的特点,使其庄重、典雅、宜人。设计丰富了内庭院的室外空间与环境,同时使各部分房间都取得了良好的景观精心的效果与采光。内部功能设计力求满足使用者的要求,同时营造出不同的室内空间效果。在建筑中轴线上的四季厅,建筑设计为1/4玻璃球体,采用薄壁圆钢管,通过经纬线形成一个完整球面,是整座建筑的精华部位,也使得建筑创意得以充分、完美的体现。

The building is used as the place to welcome VIPs home. The concept of the design is to put the building and natural environment in organic harmony and unify the whole buildings inside the guest house in styles so that it can give prominence to the specific feature of the building: stately, elegant and pleasant. The design of interior court not only enriches the outdoor space and environment, but also provides good views and sunlight for each room in different directions. Meanwhile, the interior functional design tries to satisfy the requirements of consumers and create distinct indoor space. A four-season hall is constructed on the central line of the building. The designer shapes are a 1/4 glass sphere, which is made use of thin-walled circle steel pipes and form a complete sphere through longitude and latitude. This is the essential part of the building, which makes the design concept in adequate and perfect embodiment.

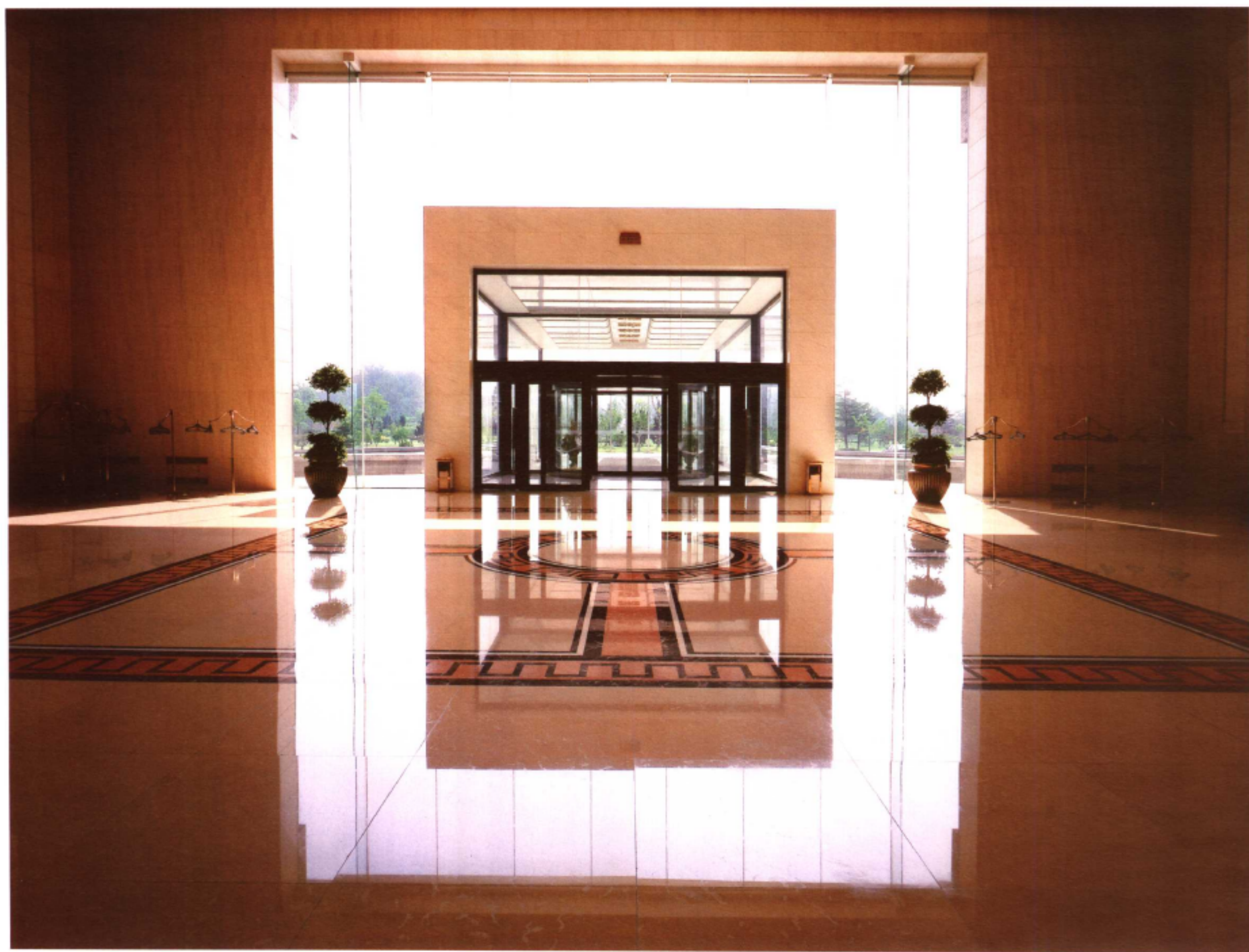
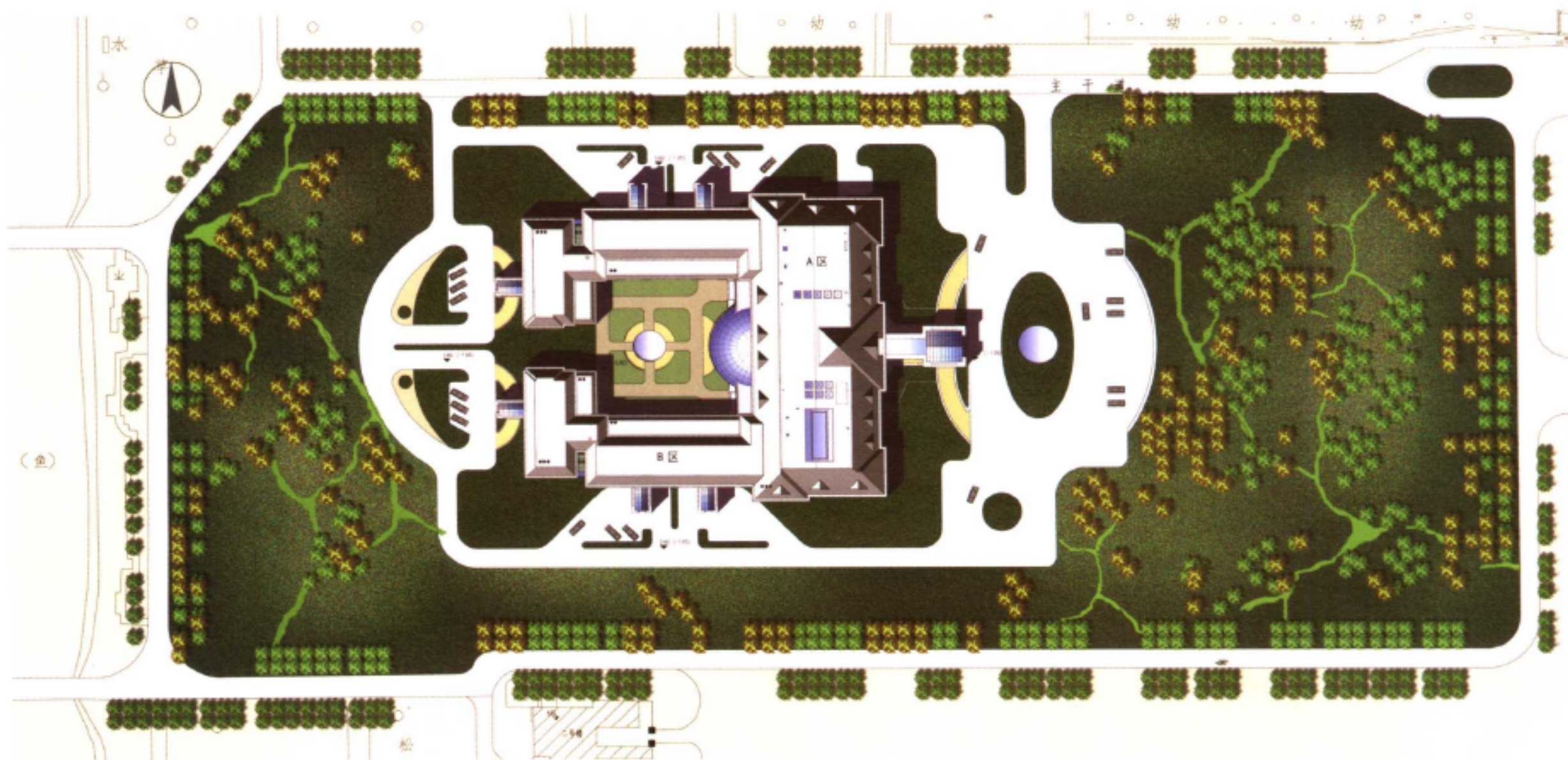









建设地点 天津市河北区天纬路

主要用途 商业、酒店

总建筑面积 148 376 m²

层数 地上26层，地下2层

总高度 99.6 m

结构形式 框剪结构

设计 / 竣工时间 2003 年 / 2005 年

Location Tianwei Road, Hebei District, Tianjin

Main Use Commerce and hotel

Total Floor Area 148,376 m²

Floor Levels 26 floors above-ground, 2 floors under-ground

Total Height 99.6 m

Structure Frame-shear wall structure

Design/Completion 2003/2005