

# YANCHENG GREENLAND BUSINESS CITY

## 盐城绿地商务城

用地面积	建筑面积	设计时间	建筑类型
57.1万平方米	131.5万平方米	2011年至2011年10月	商业+办公+住宅

绿地商务城位于盐城市东部亭湖新区的核心区域，是服务于盐城主城区160万人口，集商业中心、休闲娱乐、商贸办公、金融服务、文化会展、餐饮服务、居住生活等多种现代城市功能于一体的超大型CBD+CLD综合社区。绿地商务城的建成确立了其在亭湖区的核心地位。

Greenland Business City, located in the core area of Tinghu New District at eastern part of Yancheng City, is a super-large CBD+CLD general community integrating multiple modern urban functions, such as commercial center, leisure and entertainment, business and trade office, financial service, cultural exhibition, restaurant and residential building, serving for 1.6 million citizens in downtown area of Yancheng City. After completion, this project has become a core landmark at Tinghu District.

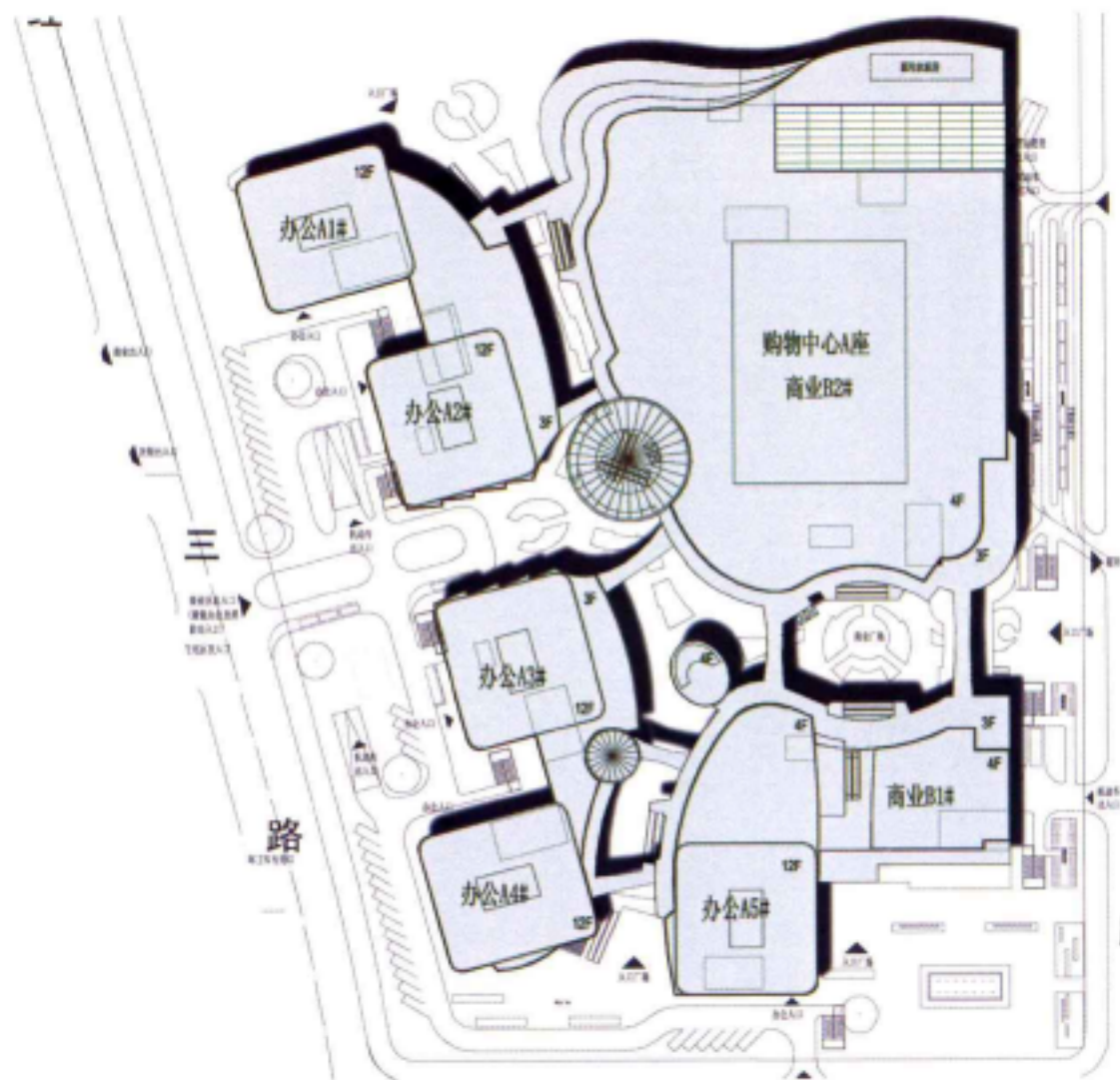

above site plan/总平面图  
right business perspective/商业透视图







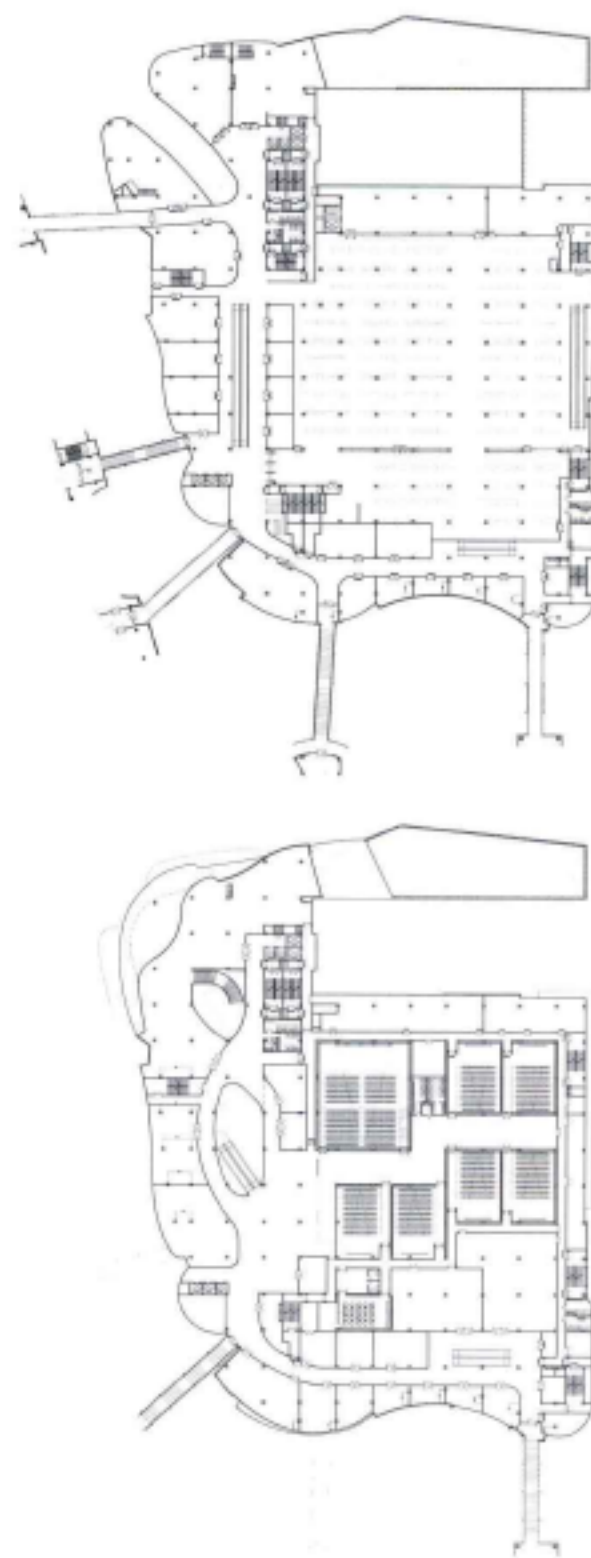
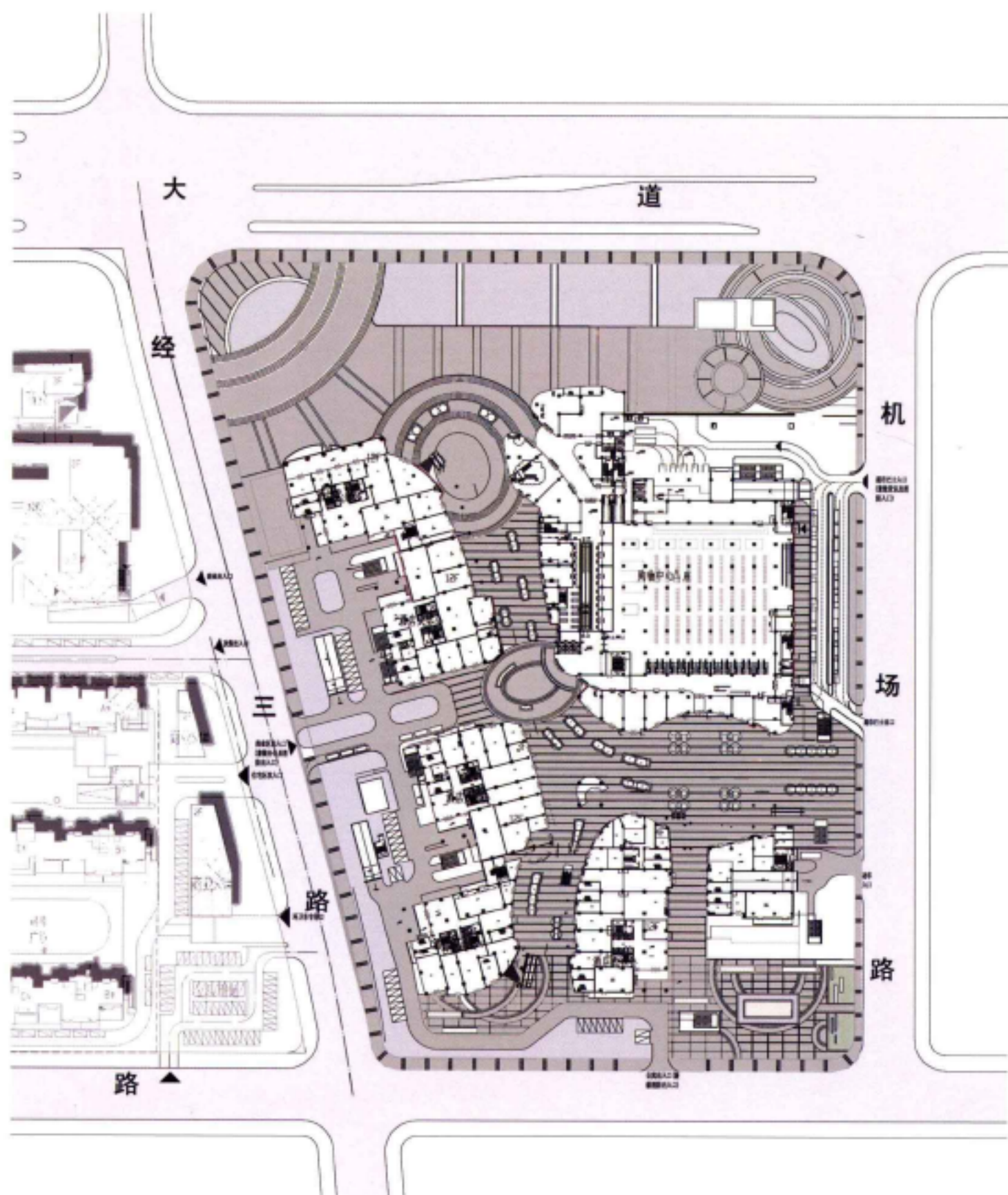

left commercial 1st floor plan/商业一层平面图  
right business perspective/商业透视图



