



Main façade 主建筑外牆

Dorset

Bryanston School

The New Science School is located within the picturesque grounds of Bryanston School. It houses the three main science disciplines, part of the maths department, and a shared lecture theatre.

The semi-circular plan for the building grew out of the aspiration to conclude the formal axis of the Norman Shaw main building and its later additions, whilst addressing the informal series of individual buildings along the route of the main drive. The three-storey building makes use of the naturally sloping landscape by having the main entrance on the middle floor so that only two levels are visible from the main school courtyard. The building focuses on a central south-facing science garden that features a pond and geodesic greenhouse.

The building has a simple construction of load-bearing brick and block walls, concrete floor slabs and a zinc-clad pitched roof. The main façade to the inner courtyard is solid load-bearing brickwork in English Bond using a high lime-content mortar. The concrete floors bear via pads onto brickwork piers, and flat arches span above window openings.

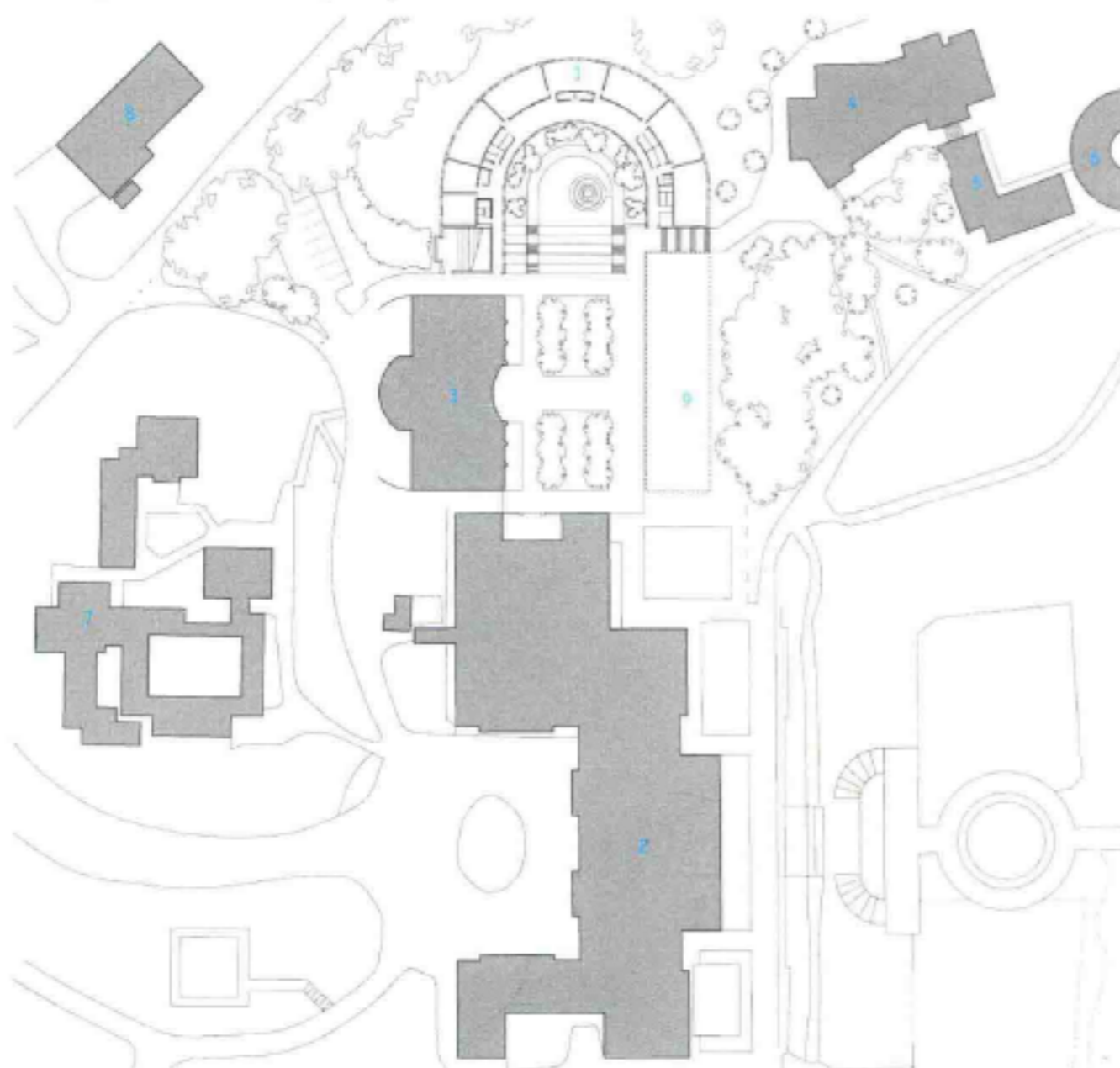

布莱恩斯顿学校

新建的理学院楼位于风景如画的布莱恩斯顿学校校园内，里面设置着三个主要理科学科教室、部分数学系教室和一个公用的阶梯教室。

这座半圆形建筑的设计灵感来自于将诺曼·肖主楼与其附加工程的中轴线，将主要车道上一系列零散的建筑连接了起来。建筑利用了自然坡度，将主入口设在了二楼，从学校的主庭院看去，三层高的建筑就像只有两层一样。建筑的中心是一个朝南的科学花园，里面的水塘和温室独具特色。

建筑采用了简单的砖砌承重墙、混凝土楼板和镀锌板斜屋顶。内庭的主墙采用了英式砖砌法，并运用了大量的石灰泥。混凝土楼板通过衬垫支撑着砖石结构，窗口则采用了平拱结构。

1. 新理学院
 2. 主楼
 3. 民主科技中心
 4. Coade大厅
 5. 艺术和戏剧教学
 6. 艺术学院
 7. 音乐学院
 8. 其他地产
 9. 未来的音乐学院
1. new science school
 2. main building
 3. CDT
 4. Coade hall
 5. arts and drama
 6. art school
 7. music school
 8. estates
 9. future music school

UK

Europe



建筑外观 External view



外部走道 External walkway



建筑外观 External view

Photo: Anthony Weller

Educational

Completion Date: 2007

Architect: Hopkins Architects