



Far view 远景

## ALSACIA

The volumes level the architecture to the lines of the perimeter, while fitting itself to the urban context and the counterfort of the cordillera, using a roundly colour scheme of red and black. The project defines itself by the use of simple lines, extreme colours and pure volumetry.

The use of the buildings (distribution and classification of auto parts) and its complexities define the architecture to a big, closed volume which terraces itself to follow the urban boundaries. The contrast between the red and black, draws attention to accent the simplicity of the volumes, transforming the architectural ensemble to a unique icon of the access to the ENEA business site. The main building contrasts with its black metal to the administrative building and the service areas due to its morphology and materiality. The second volume is made out of insight concrete, glass and steel. The suspended roof crosses the volume, bearing itself on both sides on metal columns of double height, generating covered and protected areas. An access atrium, preceded by a water pond (obey the function of chilling the main façade by evaporation) and the square in the subsequent façade assigned for social activities, contains the big stairs which cross the diagonal, dynamising the space and giving access to the educational and staff rooms.

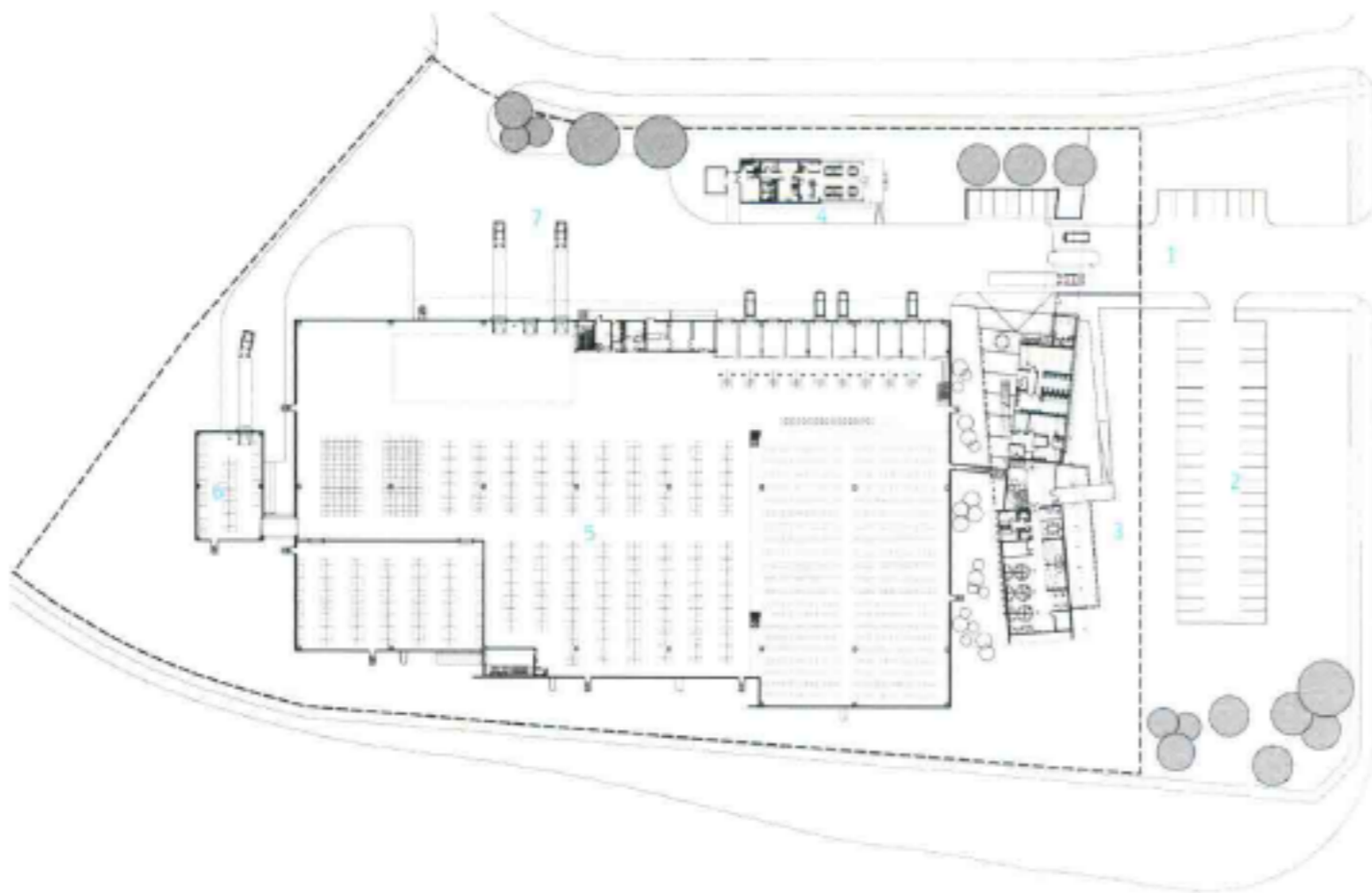

## ALSACIA公司总部

这座以红黑为主的建筑各个部分错落有致，与山脉和城市都十分相称。简洁的线条、极端的色彩和纯粹的造型使它十分显眼。

建筑的主要功能是汽车零部件的配送和分类空间，其巨大而封闭的建筑结构稳稳地坐落在城市的边缘。红黑两色的鲜明对比进一步强调了建筑的简单性，使其成为 ENEA 商业区入口处的一处显著的地标。由黑色金属板包裹的主楼以其独特的材料和造型与行政楼和服务区区分开来。二号楼由混凝土、玻璃和钢铁建成。高悬的屋顶横跨整个楼面，在建筑两侧形成了遮蔽和保护区域。入口中庭前的水塘通过蒸发来为建筑外表降温。中庭处巨大的楼梯连通了各个楼层的空间和员工办公室。

1. 入口
  2. 停车场
  3. 办公和服务区
  4. 餐厅
  5. 配送中心
  6. 危险品仓库
  7. 货车操作台
1. access
  2. parking
  3. offices and services
  4. cafeteria
  5. distribution centre
  6. storage for dangerous elements
  7. truck operation patio





黄昏景色 Sunset view

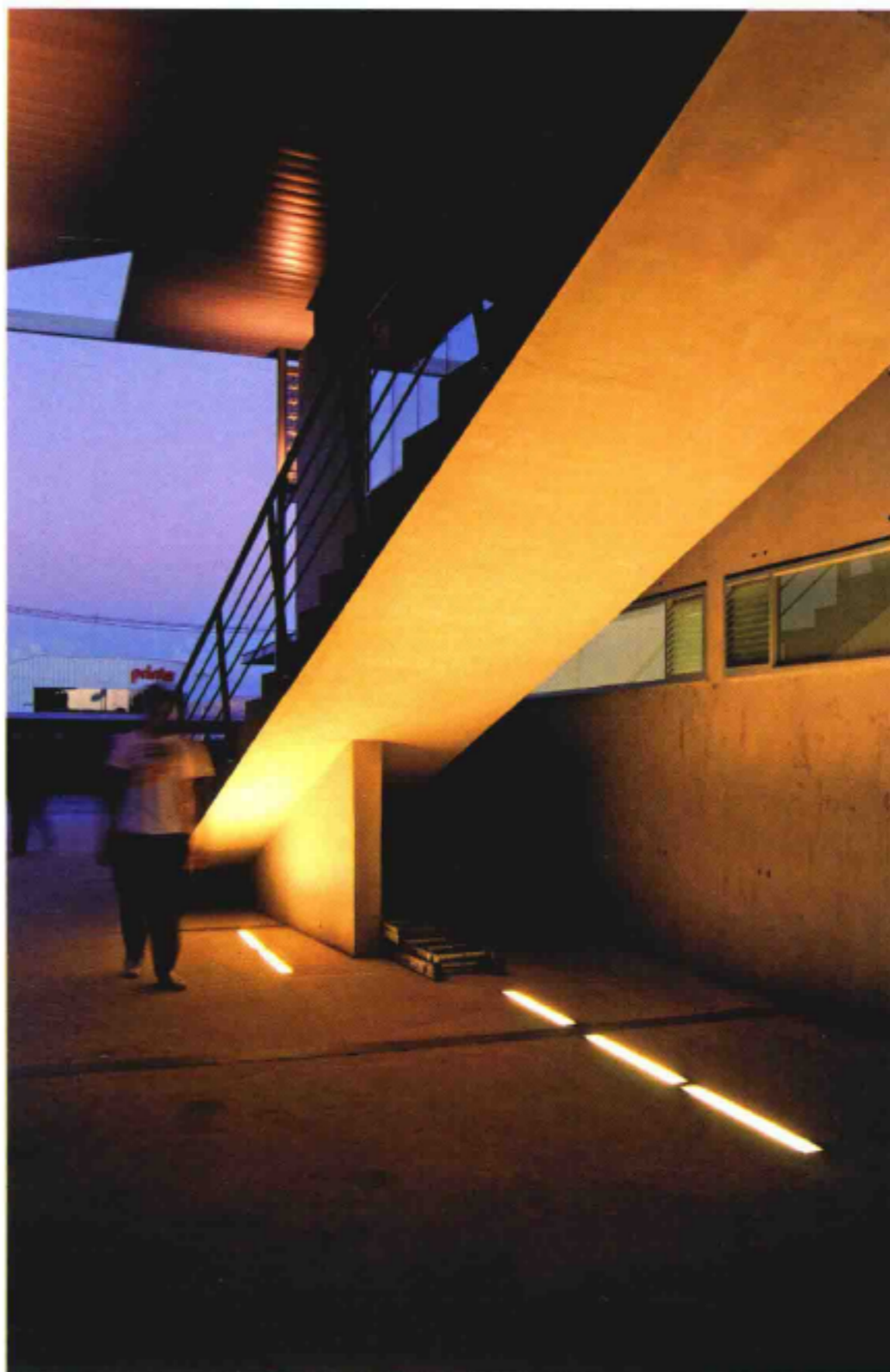

楼梯 Stairs



走廊 Corridor



廊桥 Bridge

Photo: Cristián Barahona, Guillermo Hevía H., Guillermo Hevía García

Corporate

Completion Date: 2008

Architect: GH+A Arquitectos