

# Shopping Centre Stadtgalerie

Directly located at Heilbronn's pedestrian zone, the new shopping centre "Stadtgalerie" strengthens the inner-city location. The architectural sumptuously-designed building integrates itself well into the town-space as a two-split building presenting different body languages. The Stadtgalerie Heilbronn consists of three levels which invite to stroll, a sales area of 13,000 square metres, and an attractive offer of approximately seventy-five shops and stores, cafés, and restaurants. The underground car park offers 600 parking spaces.

The cubic building with its straight and hard edge and the rounded building with the curved and soft façade melt into each other and are well integrated in the existing town-space. The independence of the buildings is especially highlighted via the façade concept. Backlit light-slits are crossing the wall area in an erratic way and thereby open the building alignment in an optical way. In the darkness the alleyway suddenly becomes a light creation. The shape softens the bulk of the building, integrateing itself in a smooth way into the surrounding building structure. A penthouse with a filigree projecting roof marks the end of the arched building shell. Vertical coloured glass lamellae accentuate the outline. Due to the different day and night impressions, the building offers varying appearances.

# Stadtgalerie购物中心

Stadtgalerie购物中心位于海尔布隆的步行街区，稳固了市中心的位置。购物中心华丽的建筑形态让它很好地融入了城市空间，两座不同的建筑呈现了不同的肢体语言。购物中心一共有三层，总面积为13,000平方米，包含75间店铺、咖啡厅和餐厅。地下停车场有600个车位。

轮廓鲜明的立方体建筑和弯曲柔和的圆形建筑完美地结合在一起，与原有的城市空间形成一个整体。建筑外墙的理念强调了建筑的独立性。背光的缝隙以一种古怪的方式横跨墙壁，从视觉上打开了建筑。小巷在黑暗中一下子就被点亮了。建筑的造型柔化了自身，与周围的建筑流畅地结合了起来。拱形外壳的最上端是有金银丝装饰屋顶的阁楼。纵向的彩色玻璃片强调了建筑的轮廓。白天和黑夜，建筑会呈现不同的面貌。



The building at night 建筑夜景

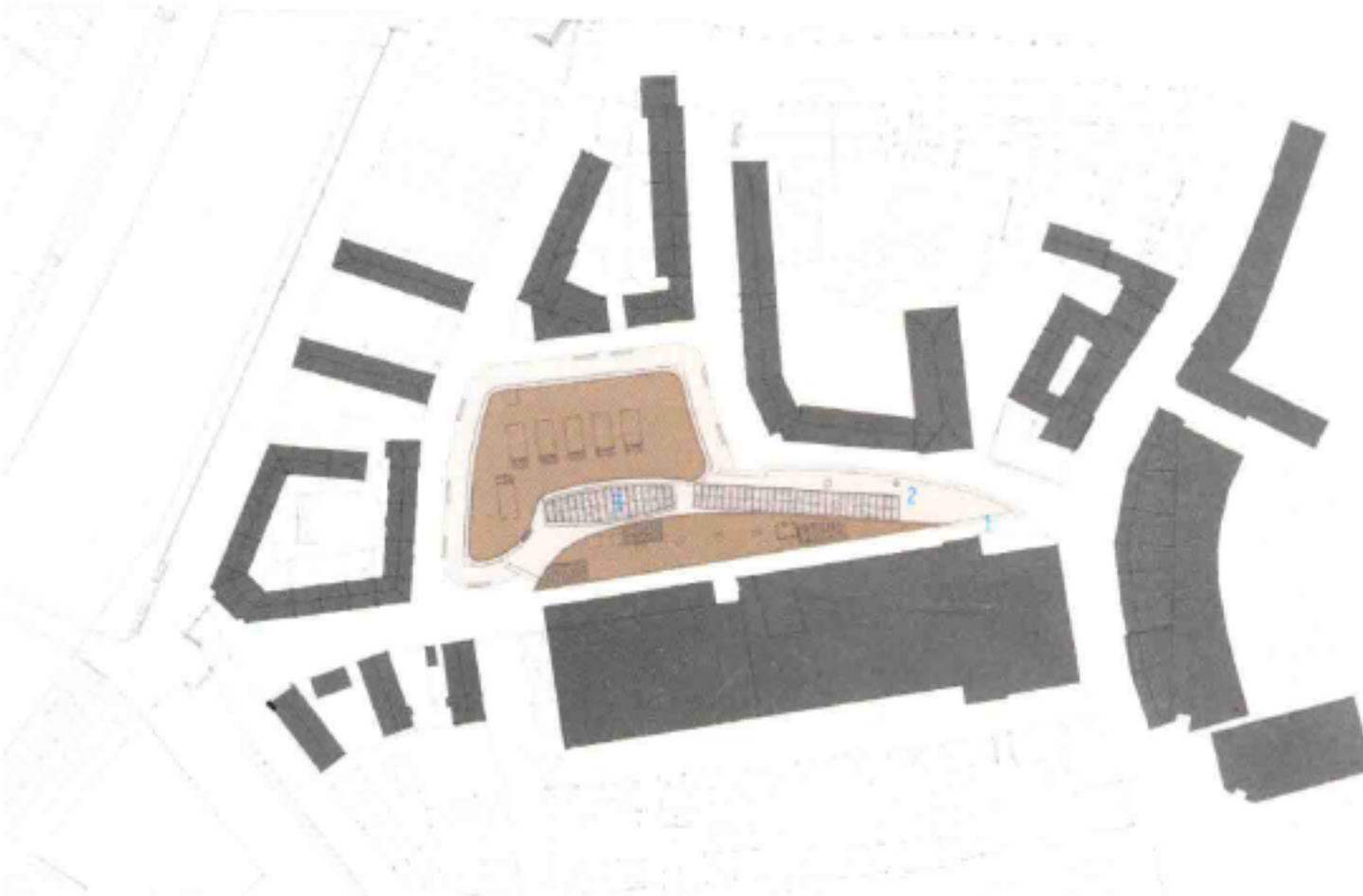

- 1. 入口
- 2. 餐厅
- 3. 屋顶
- 1. entrance
- 2. dining area
- 3. roof



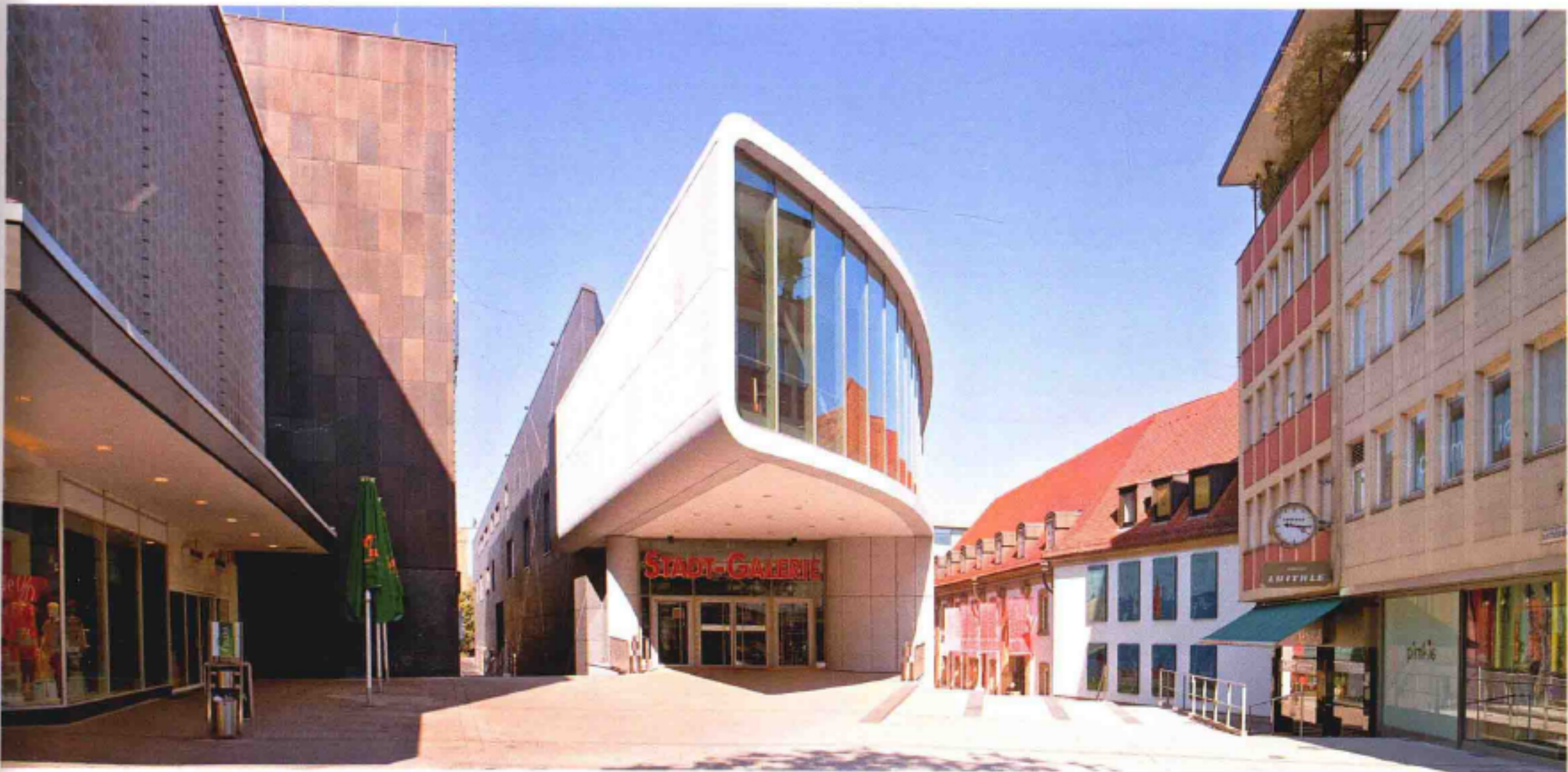

入口 Entrance



建筑正立面 Front view



室内 Interior

Photo: Blocher Blocher Partners, Stuttgart and Mannheim

Commercial

Completion Date: 2008

Architect: Blocher Blocher Partners