



View from the street 街景

Shin-Marunouchi Towers

Hopkins Architects have designed and built a landmark office, retail and restaurant development in Tokyo's most prestigious location for Mitsubishi Estate Group.

Hopkins Architects worked alongside architects, Mitsubishi Jisho Sekkei, to create a structure divided into three sections – two towers on a podium base. The six-storey podium incorporates retail and restaurants. The building's West façade looks onto one of Tokyo's most exclusive shopping streets. Conran, Prada and Hermes all have shops in the area. The offices are aimed at leading international businesses.

The commission required a mixed-use complex with large shop, luxury boutiques, restaurants, and offices for international business tenants; linked below ground level to the Tokyo Plaza metro station. The urban and intrinsic value of the project is revealed by the lightness of the volumetric relationships, the meticulous care taken over the details, the Miesian classicism of the structure that uses relationships on both the urban and human scales. The steel and glass structure resolves the relationship between architecture and its context.

新丸之内塔

霍普金斯建筑事务所为三菱地产集团在东京最繁华的区域设计了一座集办公、零售、餐饮于一身的地标式建筑。

霍普金斯建筑事务所与三菱设计共同设计了一个分为三部分的结构——两座塔楼和一个底座。六层高的底座里是商店和餐厅。建筑的西立面正对东京最高端的商业街，康兰、普拉达和爱马仕等品牌都在这里专卖店。这座办公楼试图达到世界一流的水准。

新丸之内塔地下与东京广场地铁站相连，里面包含大型商场、奢侈品店、餐厅和国际化办公空间。项目的价值体现在其轻快的连接性、精致的细节设计以及具有城市人文尺度的经典密斯式建筑结构里。钢铁和玻璃结构将建筑与周边环境有机地结合在一起。

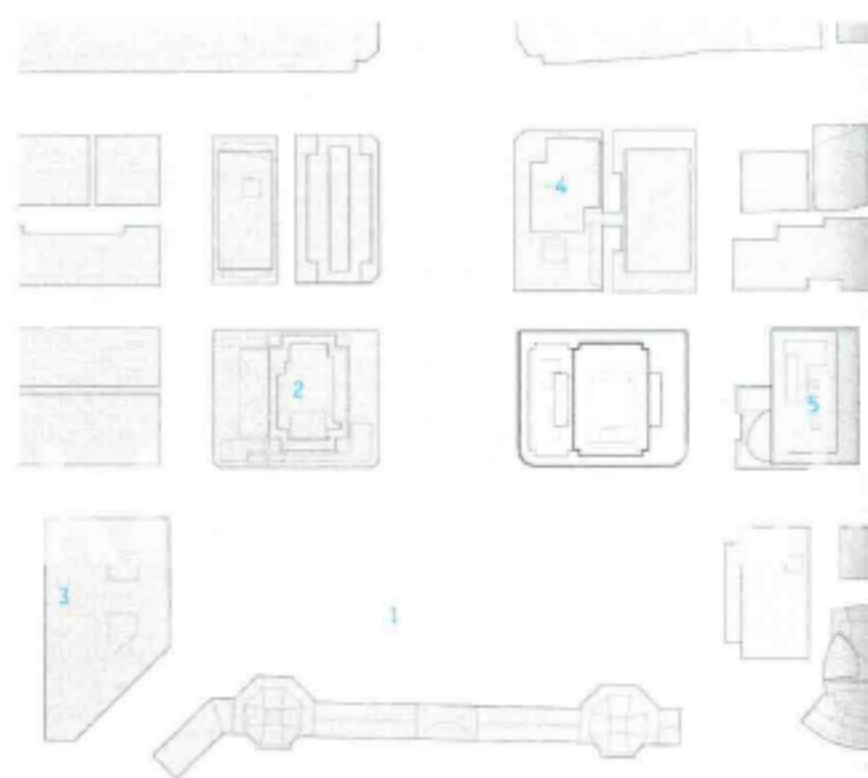

1. Tokyo Station
2. Marunouchi Building
3. Tokyo Central Post Office
4. Tokyo Marine Nichido Building
5. Industry Club of Japan/Mitsubishi UFJ Trust and Banking Building

1. 东京车站
2. 丸之内大厦
3. 东京中央邮局
4. 东京海上日动公司
5. 日本工业协会(三菱信贷银行)



全景图 General view



外部一角 Façade corner



露台 Corridor



入口 Entrance

Photo: Ken'ichi Suzuki

Commercial

Completion Date: 2007

Architect: Hopkins Architects