



General view 全景图

## Bridge School

Located at a remote village, Fujian Province in China, the project not only provides a physical function—a school + a bridge, but also presents a spiritual centre. The main concept of the design is to enliven an old community (the village) and to sustain a traditional culture (the castles and lifestyle) through a contemporary language which does not compete with the traditional, but presents and communicates with the traditional with respect. It is done by combining few different functions into one space—a bridge which connects two old castles across the creek, a school which also symbolically connects past, current with future, a playground (for the kids) and the stage (for the villagers).

A light-weight structure traverses a small creek in a single, supple bound, essentially, it is an intelligent contemporary take on the archetype of the inhabited bridge. Supported on concrete piers (which also have the function of a small shop), the simple steel structure acts like a giant box girder that's been slightly dislocated, so the building subtly twists, rises and falls as it spans the creek. Inside are a pair of almost identical wedge-shaped classrooms, each tapering towards the mid point of the structure (which holds a small public library). Although it's possible to use the building as a bridge, a narrow crossing suspended underneath the steel structure and anchored by tensile wires offers an alternative and more direct route.

### 桥上书屋

项目位于中国福建省一个偏远的小山村。它不仅仅是学校和桥的简单结合，还展示了一种内在的精神文化。现代设计并不会侵犯传统，相反，它将与传统对话，并将其传承下去。该设计的主要目的是通过现代建筑语言复兴古老的村落，传承传统土楼文化和生活方式。项目将多个功能区融为一体：一座穿过溪流连接两幢土楼的桥，一个在象征意义上连接过去、现在和未来的学校，一片操场（供学生使用），一个舞台（供村民使用）。

一个轻质结构横贯与小溪之上，基本上，它就是一个以可居住的桥梁为原型的巧妙现代设计。由混凝土基座（同时也是一个小商店）支撑的简单钢结构像一个被放错地点的巨大盒子。建筑在水面上微妙地扭曲着，一会儿上升，一会儿下降。内部结构和外部造型相似，桥内两间相同的楔形教室各自朝向桥的中央（中央是一个小图书馆）逐渐缩小。尽管也可以把建筑当成一座桥，但是悬在钢结构下面、以拉线固定的小道无疑是一条更方便的路径。

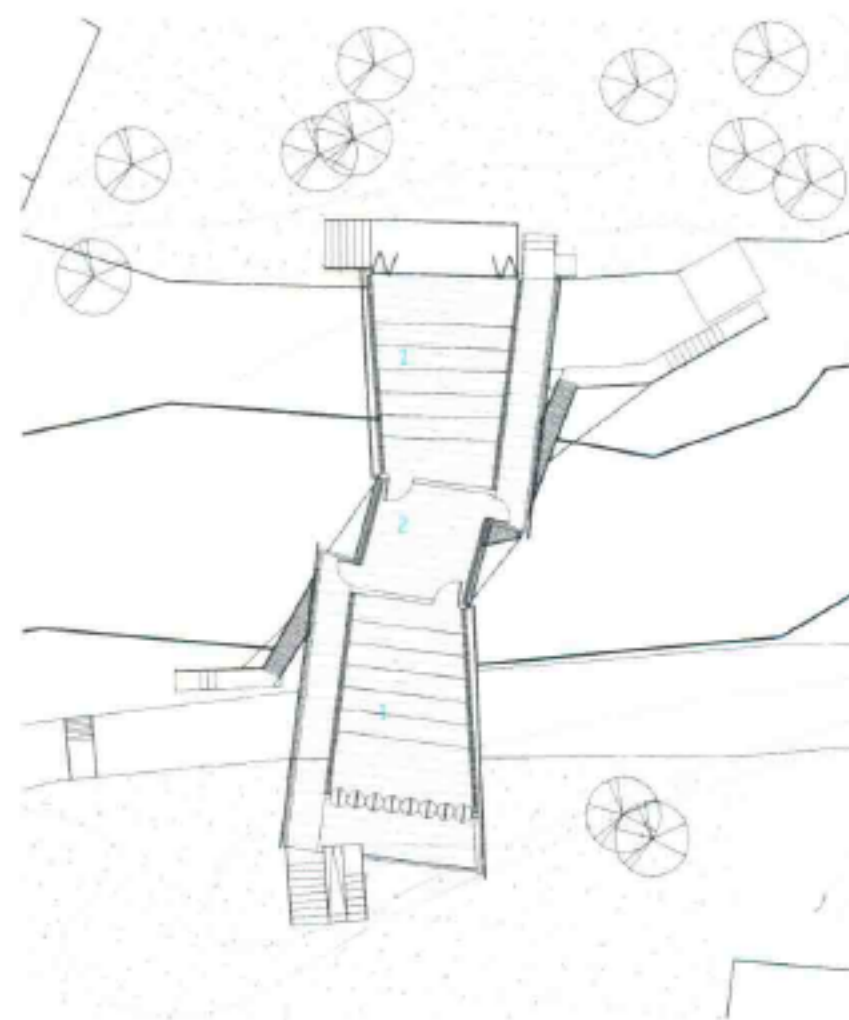
1. classroom  
2. library1. 教室  
2. 图书室





建筑细部 Details

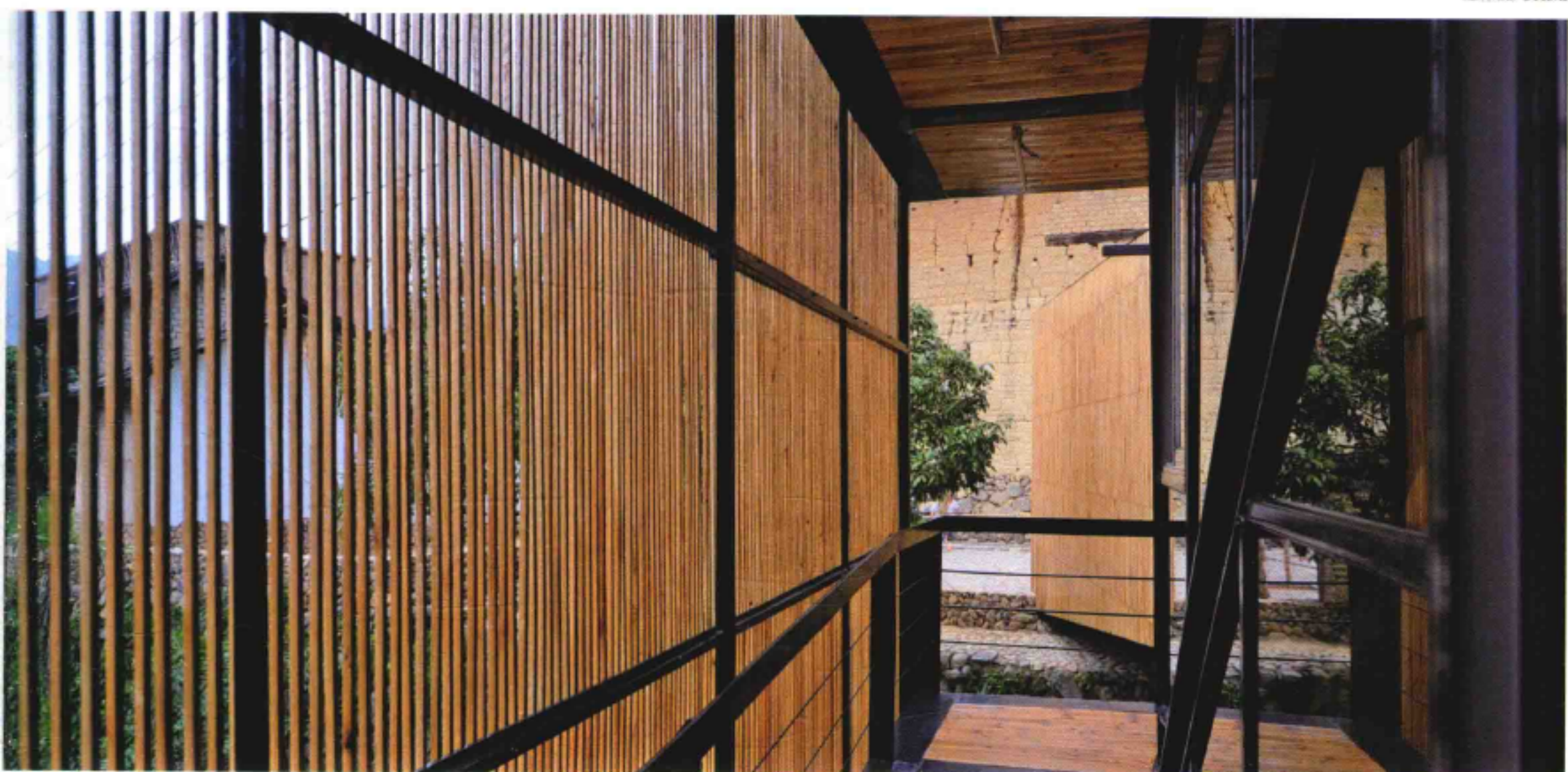

入口 Entrance



教室 Classroom

Photo: Li Xiaodong

Completion Date: 2009

Architect: Li Xiaodong

Educational