



Night view 夜景

Le Prisme

The building is a new venue for theatre, concerts, fairs and sports events. It contains retractable seating and demountable stage for versatility. The main space can accommodate up to 4,500 people during performances. As it is never permanently inhabited, the building is essentially a chamber for ephemeral events.

It is an instantly recognisable object. Three ribbons of concrete that vary in height and texture define the building. The ribbons delineate the different zones of the building: entrance, hall, storage and back of house facilities, and also create a series of residual spaces that contain services machinery and technical access. Inside, a twelve-metre-high ribbon defines a rectangle that is the hall. The hall is column free, measuring forty metres wide by sixty metres long. Externally the upper ribbon is made of prefabricated concrete panels with a regular grid of glass bricks.

During the day, the sunlight plays with the 25,000 bespoke pyramid-shaped glass bricks, producing glimmering effects and dramatic shadows. In the evening, the building awakens as the Fresnel lens-like surfaces of the glass bricks that amplify the intensity of the coloured lighting scheme, producing a glittering façade.

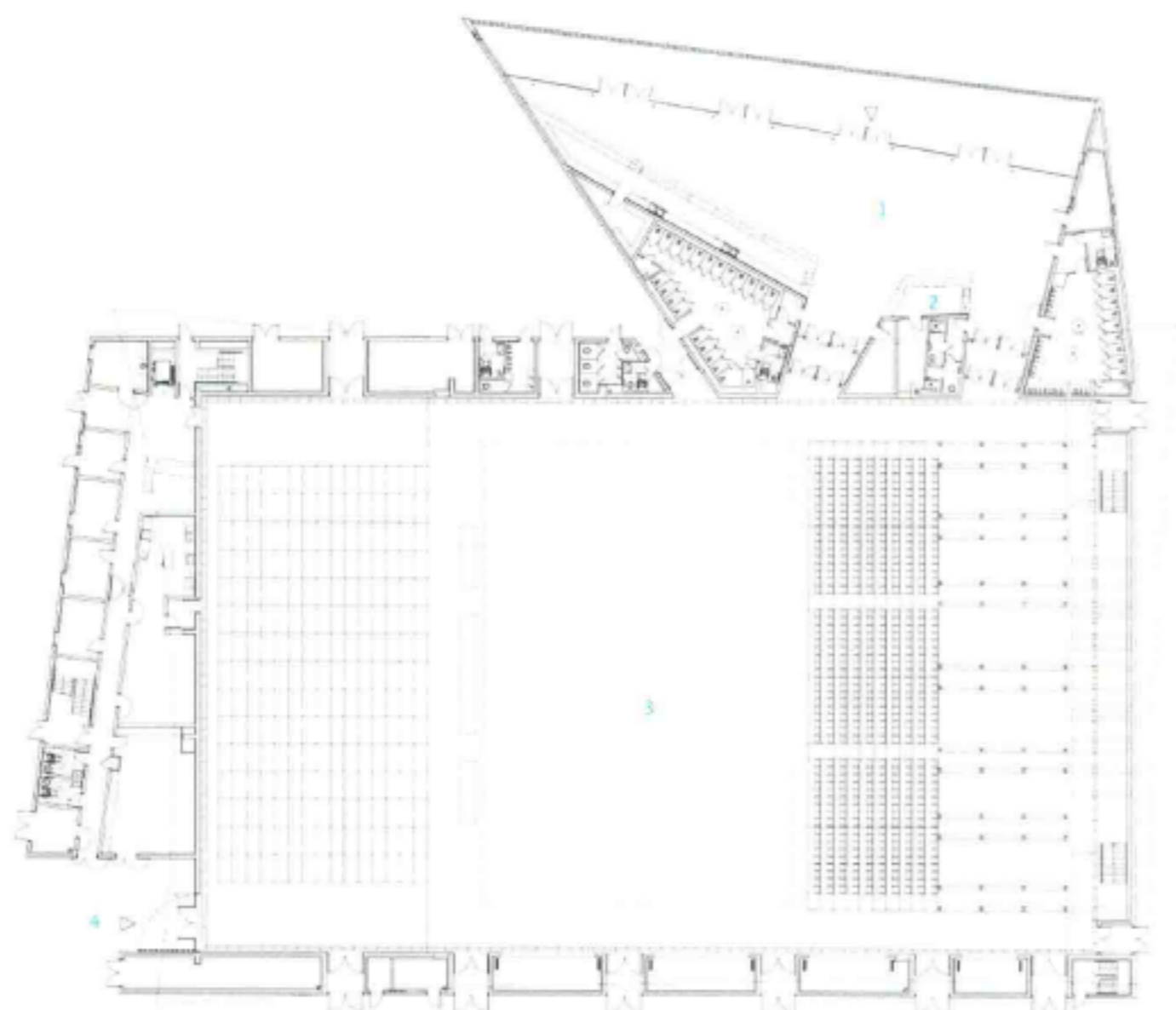

棱镜剧院

棱镜剧院内可以进行戏剧、音乐会、展会、运动会等活动。剧院内设有活动坐席和可拆卸舞台，最多可容纳4,500名观众，是一个举行临时性活动的主要场所。

建筑十分引人注目，由三个高低、材质不同的带状结构组成。这些带状结构划分了建筑各个功能区：入口、大厅、贮藏室、后台设施。此外，剧院内还有一些剩余空间，安置机械、配电设施。大厅高12米，长60米，宽40米，呈矩形。里面没有任何廊柱。上层带状结构的外部由预制混凝土板构成，上面装饰有排列规则的方格玻璃砖。

白天，阳光照射在25,000块锥形玻璃砖上，闪闪发光，形成了奇妙的光影效果。晚上，建筑外表的玻璃砖使建筑产生了菲涅尔透镜的效果，扩大了彩色光线的频谱，让建筑外墙熠熠生辉。

1. 门厅
 2. 前台
 3. 多功能厅
 4. 配送室
1. entrance foyer
 2. reception desk
 3. multi-purpose hall
 4. delivery



建筑正立面 Front view



室内 Interior

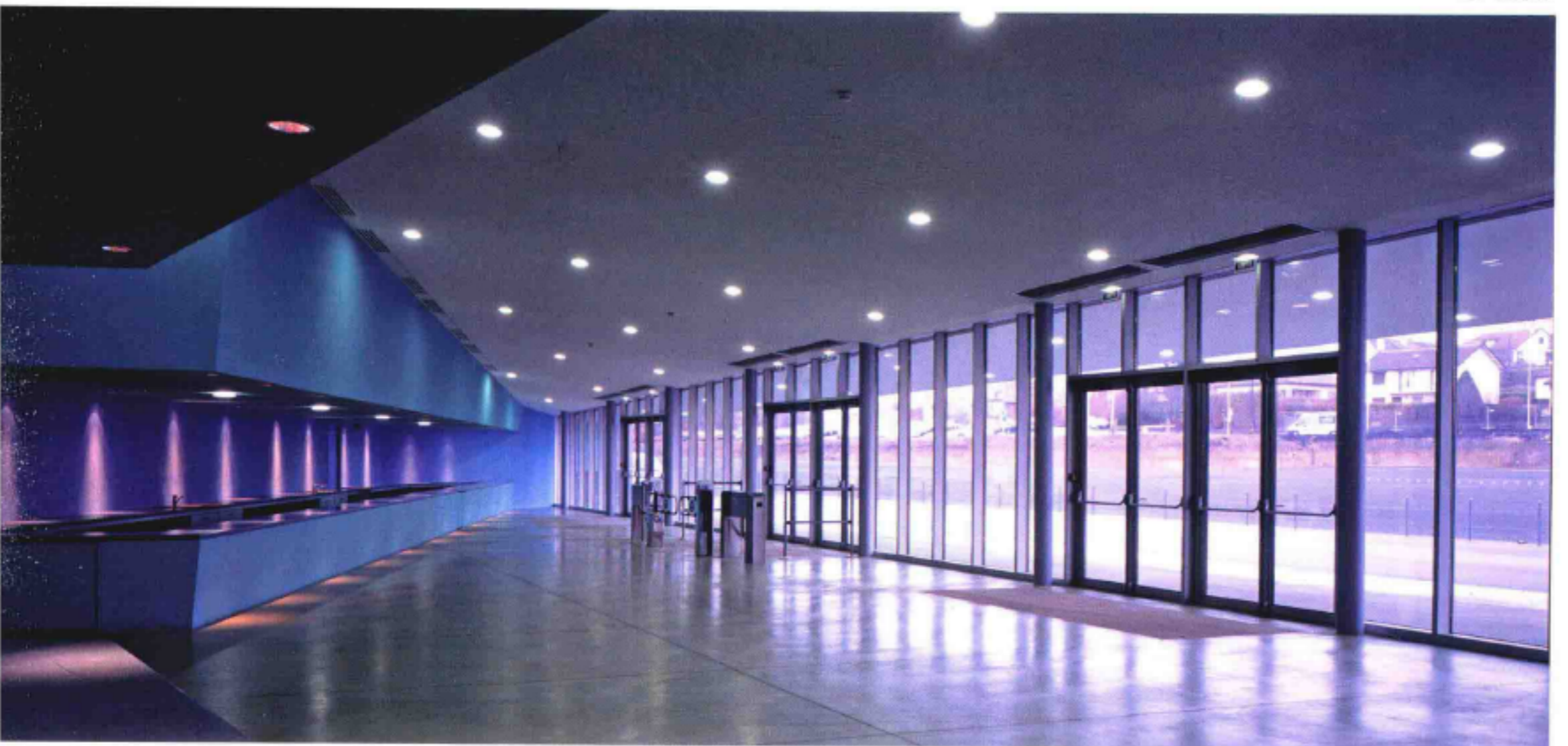

入口 Entrance

Photo: Helene Binet, Brisac Gonzalez Architects

Recreational

Completion Date: 2007

Architect: Brisac Gonzalez