



General view 全景图

Post Tower

The Post Tower, situated in one of the most critical and highly visible sites in the historic central business district of Seoul, is the south gate of Myeongdong. Three major roads and their intersections form a triangle within the city that defines the district.

The 72,000-square-metre building presents a symmetrical face and dramatic silhouette to the primarily axial approach from Namdaemun. The building is developed with a primarily stone wall to convey solidity and permanence to the place and accented with a detailed stainless steel window system to provide shadow, richness and sparkle. A super scaled gentle arch that provides a generous and welcoming entrance for the project defines the lobby and main postal hall. The building is sited to the east of the site to maximise the public space in front of the project and create a memorable urban place that accepts the many pedestrian movements through and across the site.

Programmatically the first three floors contain the public postal spaces and the office lobbies. The next six floors contain postal sorting operations on large floor plates to minimise vertical movements. As the tower breaks into two individual towers, the central postal authorities occupy the south tower and the north tower is speculative office space to generate income for the owner. The tenth floor becomes the community centre for the project and contains dining, meeting and lounge spaces for the users all centred on a large exterior terrace.

邮政大厦

邮政大厦位于首尔最重要的历史文化商业中心——明洞的南大门，十分抢眼。三条主要街道在这里相交叉，形成了一个三角形区域。

大厦总面积为72,000平方米，呈夸张的对称结构，正好坐落在南大门的中轴线上。建筑的石墙体现了它的坚固和持久性，而不锈钢窗口系统则为建筑增添了光彩和丰富了细节。巨大的弧形拱门为大厅和主邮政厅提供了一个温馨而大方的入口。建筑位于空地的东侧，使建筑前方的公共空间得以最大化，营造出一个令人难忘的城市空间，为行人提供了多条通道。

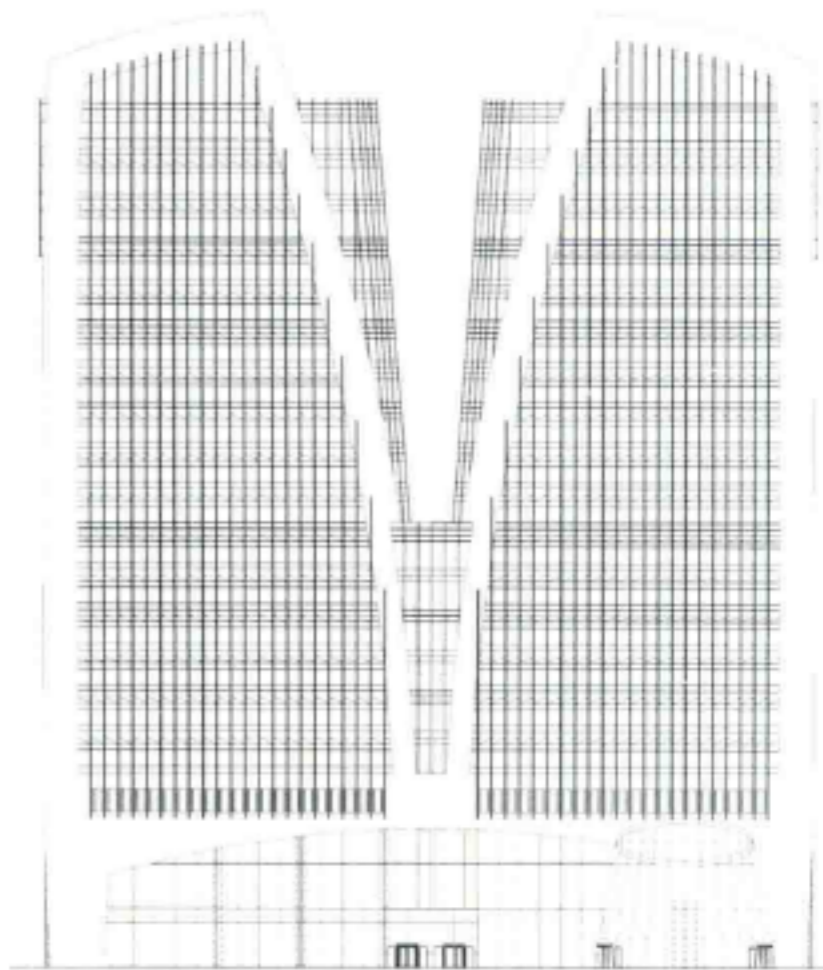

Elevation 立面图

大厦的下面三层是公共邮政空间和办公大厅。往上的六层是邮件分类作业区，楼面布局开阔，适合垂直运动。上方的塔楼一分为二，南侧是中央邮政机构，北侧是用于出租的办公空间。大厦的十楼是社区中心，餐饮、集会和休闲空间都集中在一个开阔的露天平台上。



夜景 Night view



入口 Entrance

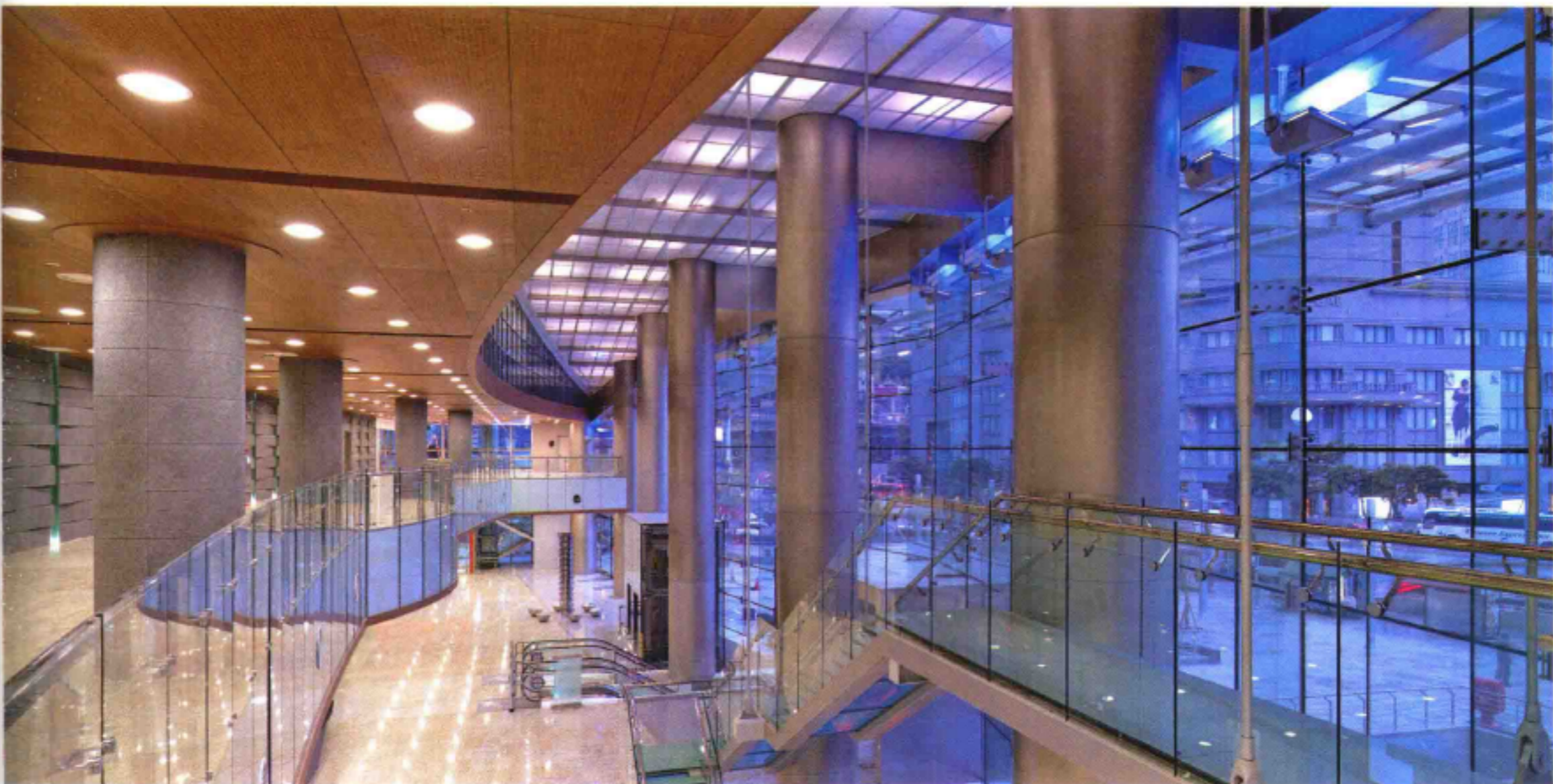

中庭 Hall

Photo: Young-Kwan Kim

Completion Date: 2009

Architect: DeStefano and Partners, Ltd.

Commercial