

百度大厦，北京，中国

Baidu Headquarters, Haidian District, Beijing, China, 2009

主持建筑师：汪恒

Principal Architect: WANG Heng

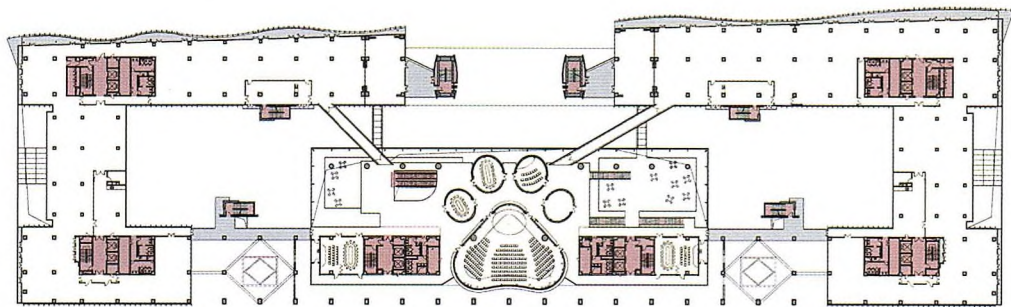
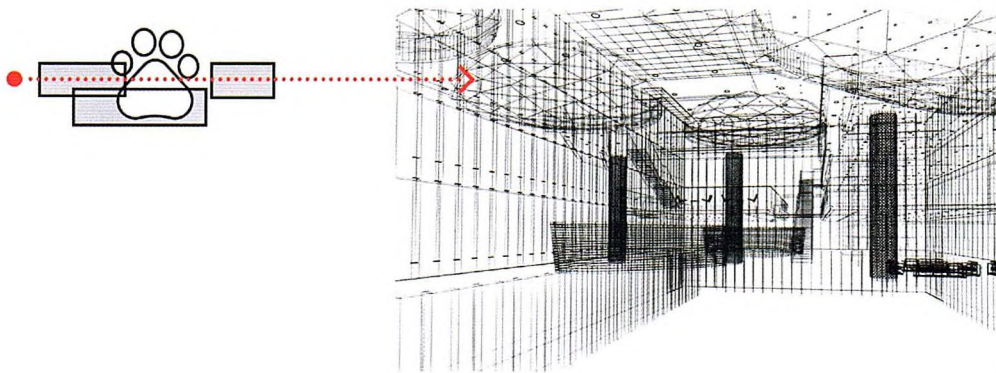
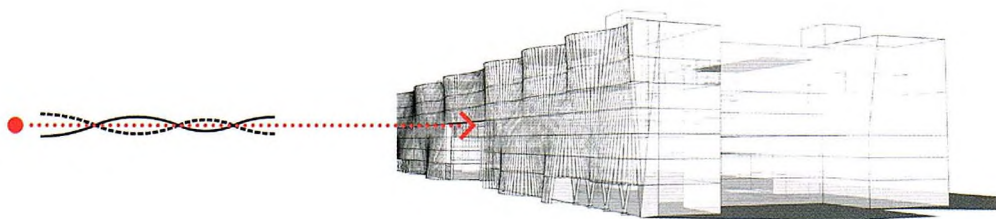
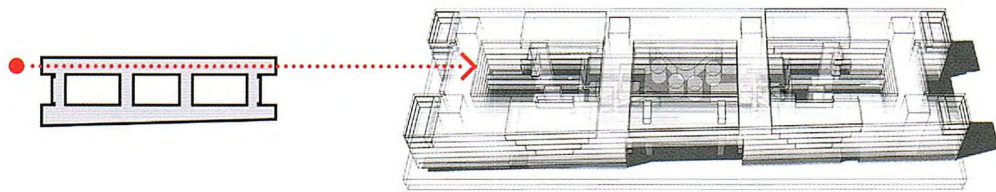

百度大厦是百度公司的总部和研发大厦，设计以百度公司的“简单，可依赖”核心理念立意，以“建筑逻辑简单理性，建筑空间丰富感性”为建筑设计理念，采用“外部形象简洁完整大方，内部空间多样变化灵动”为建筑语言贴切地表达，创造出具有中国传统神韵的、丰富体验性的、充满阳光、空气和绿色的高品质建筑空间并具独特建筑形象的现代办公建筑。

建筑总体平面设计为一个完整的“目”字形，已被百度人亲切地称为“搜索框”，南、中、北3个办公单元，与中央的公共单元共同围合成3个相互贯通的院落，平面功能清晰实用。

西侧严谨匀质的银灰色金属翼与东侧变幻起伏的白色玻璃翼，强烈地表达出简单与复杂、理性与感性的对立统一，含蓄地诠释了百度公司的企业文化。

大厦主体办公空间穿插着的“九大公共空间”，形成一种立体连贯的空间网络，为使用者创造了中国园林式的步移景异的四维丰富体验。□

The building is Baidu Inc.'s headquarters and office for research and development. The design originates from the company's core concept of "simplicity and reliability", proposing "simple, rational architectural logic" and "rich, perceptual architectural space". Its architectural vocabulary can be described as featuring "simple, complete and generous exterior" and "diverse, variable and flexible interior", which together create a bright, green modern office building with traditional Chinese spirit and distinctive architectural image.

The general layout takes the form of the Chinese character "目" (i.e. the "eye"), which Baidu workers have nicknamed as the "search box". Together with the central public area, the 3 office units – south, central, and north – enclose 3 interconnected courtyards, in which various functions are clearly delineated.

The west wing in rigorous and homogeneous silver-gray metal and the east wing in undulating white glass strongly express the unity of opposites between simplicity and complexity, rationality and sensibility – an implicit interpretation of Baidu's enterprise culture.

Weaving into the building's main office area, the "9 public spaces" form a continuous 3-dimensional spatial network, creating an even richer 4-dimensional experience of "varying sceneries with changing viewpoints" which is characteristic of Chinese gardens. □

项目信息/Credits and Data

客户/Client: 百度在线网络技术(北京)有限公司/Baidu Online Network Technology (Beijing) Co., Ltd.

设计单位/Design Institute: 中国建筑设计研究院/China Architectural Design Institute Co., Ltd.

设计团队/Design Team: 汪恒, 时红, 曾宁燕, 郑菲, 沙松杰, 曹莹, 李博华, 周莹, 朱荷蒂, 罗颖, 叶蕾/WANG

Heng, SHI Hong, ZENG Ningyan, ZHENG Fei, SHA Songjie, CAO Ying, LI Bohua, ZHOU Xuan, ZHU Hedi, LUO Ying, YE Lei

设计时间/Design Period: 2006.07-2007.03

竣工时间/Completion: 2009.09

建筑面积/Floor Area: 91,500m²

摄影/Photos: 张广源, 曾宁燕/ZHANG Guangyuan, ZENG Ningyan

1 分析图/Diagrams

2 三层平面/Floor 2 plan

3 外景/Exterior view

4 内景/Interior view



3



4