

BEIJING MIYUN FLOWER CITY TEMPORARY SALES BUILDING

北京密云国际花都临时售楼处

用地面积	建筑面积	设计时间	建筑类型
7.56万平方米	20.87万平方米	2010年8月至今	商业及中高层住宅

该项目位于密云区域后街与新西路之畔，隶属于密云西区。作为临时售楼处，必须满足快速建造、经济合理、高品质感等多种要求。建筑巧妙运用双层表皮的概念，内层表皮是古典样式的外墙，但采用最为经济的涂料，外层表皮采用花格窗、磨砂玻璃和局部石材等古典建筑元素，两层表皮有机地融合在一起，古典与现代，细腻与精致，优雅地展现在人们面前。特别是在晚上，内层泛光照明进一步凸显两层表皮的层次感和空气感，产生一种朦胧的意境。空间、细节、表皮赋予建筑的不只是对建筑经典设计的追忆，并赋予它在不同光线的交互作用下给人一种光影流转的视觉享受，带给建筑一种特别的动态品质。

The project is located by the side of Chenghou Street and Xixi Road in Miyun District, belonging to Miyun West Zone. As a temporary sales building, it must possess several characteristics, such as fast construction, economic feasibility and high quality, etc. The building skillfully adopts double-skin concept, where the inner layer is a classical external wall but is painted with economic coating, while the outer layer is made of patterned grid, ground glass and stone at local position to show the elements of classical building. Both layers are organically organized to integrate classical and modern characteristics, delicacy and refinement. Especially at night, flood lighting designed on the inner layer enhances the visual impact of double-layer skin and ventilation effect, producing a filmy feeling. Space, detail and skin not only evoke classic architectural design, but also provide a visual experience in light and shadow generated by interaction among different lights, realizing a special dynamic effect.

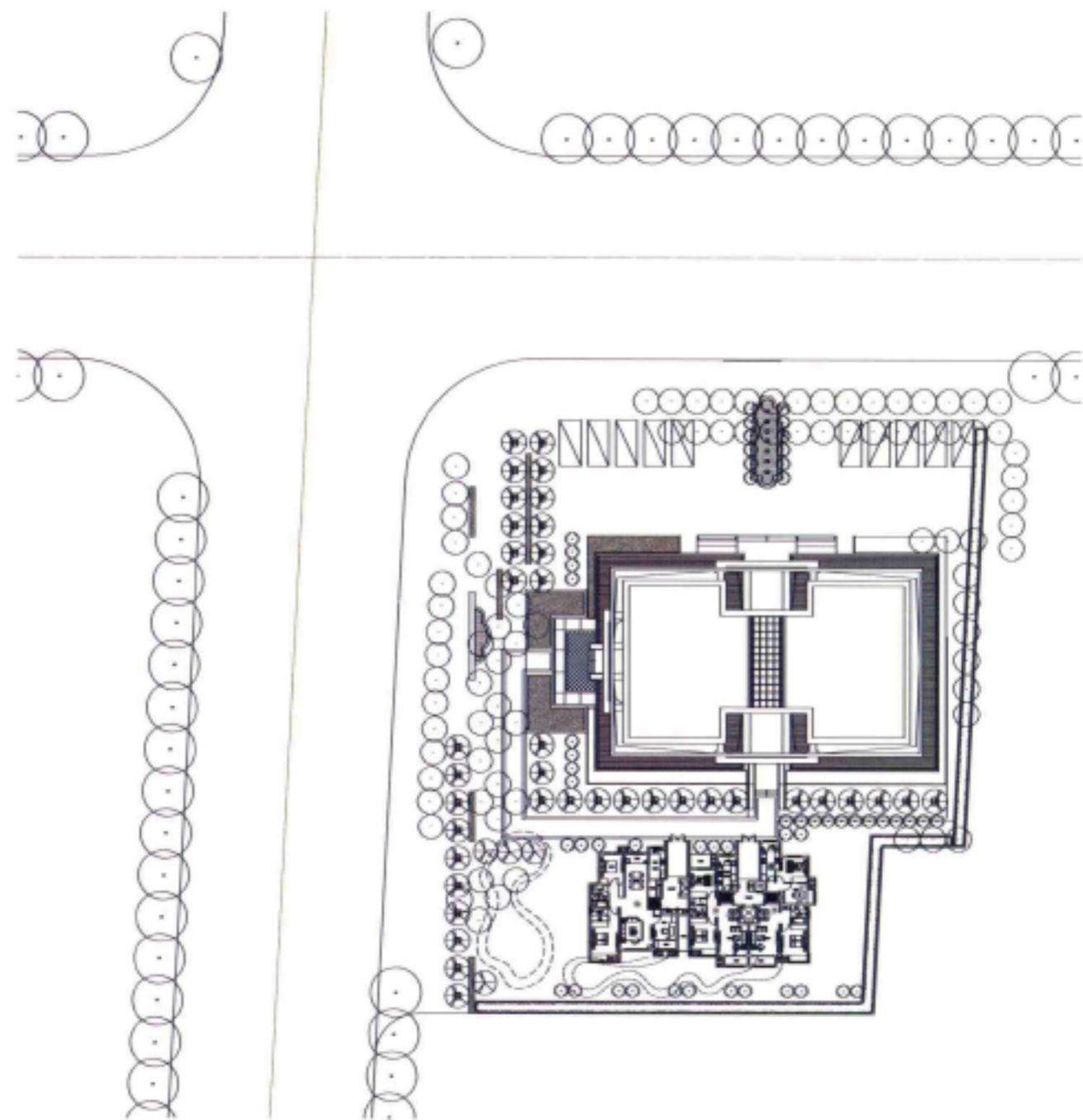

left site plans/总平面图
below club facade/会所立面











left local club facade/会所立面局部
above local club/会所局部
below corner of the indoor/室内一角

